

ROTARY INTERNATIONAL DISTRICT 3292 NEPAL-BHUTAN

ROTARY CLUB OF YALA

बाल्यवी ज्ञान मल



CREATE HOPE
in the WORLD

Souvenir
27th Anniversary
2023/24





CREATE
in the W



NIMB

केटा केटी बचत खाता

उज्ज्वल भविष्यको लागि
NIMB बाट गरौं शुभारम्भ



विशेषताहरू:

- ❖ निःशुल्क डेबिट कार्ड र मोबाइल बैकिङ्ग
- ❖ बैंकको तर्फबाट रु. १००/- खातामा जम्मा गरिदिने



NIMB

नेपाल इन्भेस्टमेन्ट मेगा बैंक लि.
NEPAL INVESTMENT MEGA BANK LTD.

+977-1-4242530, 9851147829, 9851145829
info@nimb.com.np, helpdesk@nimb.com.np
www.nimb.com.np

समृद्धिको पथमा सँगै अघि बढ्दै

सुरक्षा दिने
भनेको आफ्नैले
त हो नि !

आफ्नो भनेको
आफ्नै हुन्छ



तपाईंको सुरक्षा हाम्रो प्राथमिकता

राष्ट्रिय वाणिज्य बैंकका विभिन्न शाखाहरूमा रहेका हाम्रो लकर सुविधा प्रयोग गरी आफ्नो सामानको सुरक्षा गर्नुहोस् ।

राष्ट्रिय वाणिज्य बैंक लि. केन्द्रीय कार्यालय,
सिंहदरबारप्लाजा, काठमाण्डौ
फोन: (९७७-९) ४२५-२५९५ | फ्याक्स: (९७७-९) ४२५-२९३९
इमेल: rbb.info@rbb.com.np | वेबसाइट: www.rbb.com.np



नागरिक लगानी कोष अनलाईन फाँटवारी ढाखिला गर्ने प्रक्रियाहरू

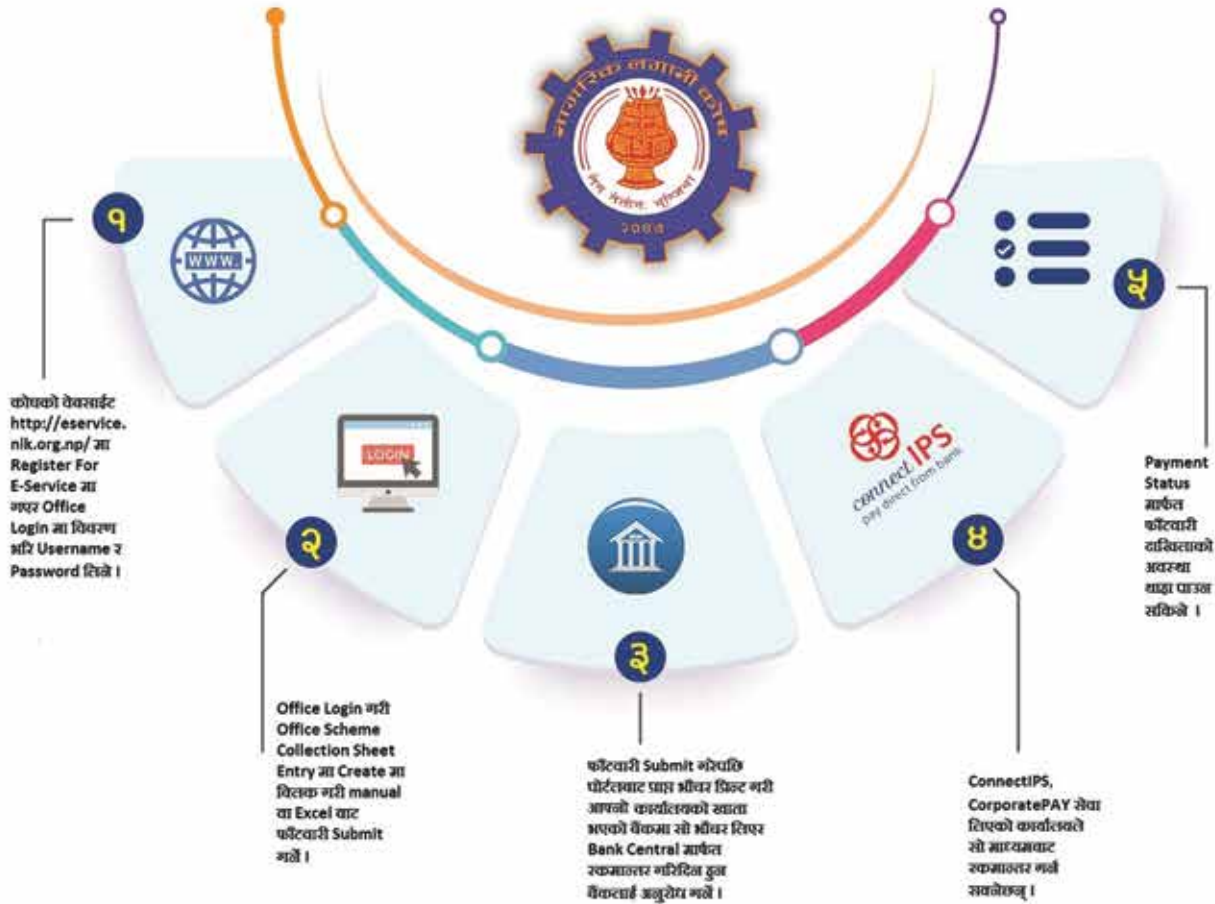

नोट

फाँटवारी Submit गरे पछि मात्र बैकमा जाने ।



नागरिक लगानी कोष

केन्द्रीय कार्यालय, नयाँ बानेश्वर, काठमाडौं

फोन : ०१-५९७०२०१

वेबसाइट : www.nlk.org.np

FOUNDER OF ROTARY



Paul P. Harris
1869-1947

Paul Harris, the father of Rotary Movement was born on April 19, 1868. When he passed away on January 27, 1947, he left behind for mankind a rich legacy of fellowship and brotherhood for international understanding and service to humanity. Today, the seed he sowed in 1905, has blossomed into a large tree having more than 1.2 million members from more than 34,000 clubs in 200 countries.

Souvenir Publication Committee

Editor:

Rtn. PP Dhruva Man Pradhan

Member:

Rtn. Col Retd Er. Sanjaya Shrestha
Rtn. Om Krishna Shrestha

Advisors:

Rtn. PP Kiran Shrestha
PP.Rtn. Deepak Kumar Shrestha

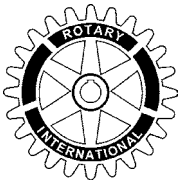

Published by:
ROTARY CLUB OF YALA,
Rotary Club of Yala meeting venue:
Le Bagaicha Restaurant,
Jawalakhel, Lalitpur, Nepal.
Meets on Friday at 17:30 Hrs.
President's Cell No.: 977-9841343792
email: shobhadevishrestha@gmail.com
website: www.rotaryclubofyala.org.np

layout designed by: Sawana Shrestha
kiranshrestha1959@gmail.com

Contents

| | |
|---------------------------------------|----|
| RI President's Message 2023-24 | 5 |
| DG Message 2023-24 | 6 |
| DGE Message 2023-24 | 7 |
| AG Message 2023-24 | 8 |
| President's Message 2023-24 | 9 |
| President's Message 2022-23 | 10 |
| Anns President's Message 2022-23 | 11 |
| Anns President's Message 2023-24 | 11 |
| Rotaract President's Message 2023-24 | 12 |
| Editorial | 13 |
| RC Yala Board of Directors and Roster | 15 |
| RC Yala Anns Executive Committee: | 25 |
| Rotaract Club of Yala BOD | 25 |
| Interact Club of Yala BOD | 25 |
| Sister Club Agreement.... | 26 |
| Engaging RC Yala in Godawori.... | 27 |
| "Dream of Clean Nepal" | 32 |
| WASH in Phulchowki..... | 33 |
| Livelihoods and Distribution | 35 |
| Rotary Year 2022/23 Activities | 41 |
| Rotary Year 2022/23 Anns Activities | 63 |
| नेवा तजिलजियात हिउपाह्य्मा:गु | 66 |
| Panch Pokhari:..... | 67 |
| Strategic Plan of RC Yala | 71 |
| Bylaws of Rotary Club of Yala | 75 |

NEPAL
CANCER
HOSPITAL
& Research Center Pvt. Ltd.
"Care with Excellence"

qualityaustria
SYSTEM CERTIFIED
ISO 9001:2015 No. 238886

अन्तर्राष्ट्रिय स्तरको सुविधा युक्त हस्पिटल
अब सम्पूर्ण सेवा एउटै छानामुनि



मेडिकल अन्कोलोजी

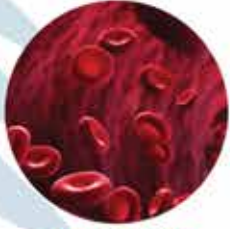

हेमाटोलोजी



पेडियाट्रिक अन्कोलोजी



पल्मोनोलोजी



रेडिएसन अन्कोलोजी



सर्जिकल अन्कोलोजी



गाइने अन्कोलोजी



कार्डियो थोरासिक अन्कोलोजी

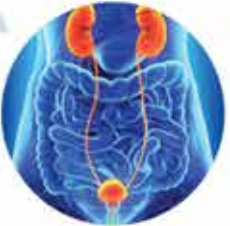

युरो अन्कोलोजी



कोलोरेक्टल सर्जरी



हेड एण्ड नेक अन्कोलोजी



न्युरो सर्जरी



प्याथोलोजी



कार्डियोलोजी



नेफ्रोलोजी



अर्थो तथा फिजियोथेरापी



रेडियोलोजी



डाएटरी



ग्यास्ट्रोइन्टेरोलोजी



निरोगी वेलनेश क्लिनिक

ROTARY INTERNATIONAL



R. Gordon R. McInally
President, 2023-24
Rotary International
T +1-847-866-3467
F + 1-847-328-4101
gordon.mcinally@rotary.org



Rtn. Shobha Shrestha,
Rotary Club of Yala

I congratulate you on your installation to the office of club President at the Rotary Club of Yala, Nepal.

You have been handed the reins of leadership at an historic moment. In the wake of the COVID-19 pandemic, more people than ever feel hopeless. Many have lost people close to them. Social networks have been uprooted and divisions have grown wider as opportunities for connection have been lost.

Rotary's ability to create lasting change begins with the bonds we form with each other. This year, I need your help to ensure the bonds between our fellow Rotary members are strong enough to bring hope to those who need it most.

Join me in making Rotary a source of strength for all of those, both within and beyond our membership, who feel they have lost hope. Let this be the year we Create Hope in the World, and let Rotary be known as an organization that takes care of its members as well as the people we serve.

It is within your power to help bring peace and soothe those afflicted by conflict, both in their communities and in themselves.

I look forward to working beside you as we come together to Create Hope in the World.

Warmest Regards,



R. Gordon R. McInally
President, Rotary International 2023-24



CREATE HOPE
in the WORLD

ROTARY INTERNATIONAL
RI DISTRICT 3292

Rajendra Prasad Dhoju
DG 2023-24



Message from District Governor 2023-24



Rtn. Shobha Devi Shrestha
President
Rotary Club of Yala

Dear President and Rotarian Friends
First of all, I would like to congratulate you and your team for RY 2023-24 and would like to offer my best wishes to you, your dream team and all the members of your club for a successful tenure.

I feel immense pleasure for getting an opportunity to express my views and happiness through this club Souvenir of RY 2023-2024. This club Souvenir is one of the important documents and covers the information of the club. I hope this Souvenir will definitely give more information about the team members to make strong coordination and communication among those Rotarians who are dedicated to make better world.

Rotary International President of RY 2023-2024, R. Gordon R. McNally called for members to capture the world's attention and lead the way toward possibilities far beyond our current expectations. McNally, revealed the 2023-24 presidential theme "Create Hope in the World". He urged members to promote peace in troubled nations, help those affected by conflict, and maintain the momentum of initiatives begun by past leaders.

We must understand that we, Rotarians, engage ourselves in service projects for the poor and needy communities and we can change the lives of those who are suffering. Rotary leadership, despite the fact that lasts only for one year, can be life changing if we can use the potential of our team and members of the club.

The theme of RI District 3292 for Rota Year 2023-24 is "Light of Hope".
Hope your club will go out all the way to achieve the RI Theme "CREATE HOPE IN The WORLD"

With regards,

Rotary District Office,
Thapathali, Kathmandu
Nepal

Cell: 977 9857020090
dhoju99@gmail.com
Rajendra Prasad Dhoju
District Governor 2023-2024

ROTARY INTERNATIONAL
RI DISTRICT 3292



Message from DGE 2023-24



Dear President Rtn. Shobha and Fellow Members,

Congratulations on your publication of “Annual Souvenir”.

It's been almost three decades since the Charter President Late Dr. Kedar Lal Shrestha and this team laid the foundation of this club. With time, experience and hard work of its members all these years, your club has become stronger and more vibrant.

I am aware of the excellent projects you have carried out to help and uplift the community, keeping in mind the Rotary Motto of “Service Above Self”. All your projects from building toilets in order to encourage girls to attend school, raising awareness of cancer, supporting cancer patients financially, conducting free eye checkup camps for children and providing scholarships to needy students are truly commendable .

RI President Gordon R. McNally has given a wonderful theme “Create Hope in the World”. So let us act accordingly to create hope by rendering our magnanimous services. Once again it is my great pleasure to extend my best wishes to all of you for a successful year.

Warm Regards

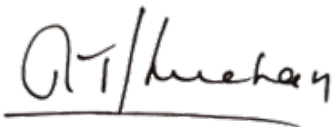

Yours – in – Rotary

Rajendra Man Sherchan
District Governor 2024 -25

ROTARY INTERNATIONAL
RI DISTRICT 3292



Message from AG 2023-24



My heartiest congratulations to you Madam President Rtn. Shobha Devi Shrestha and to the new set of Club Board and Officers of the Rotary Club of Yala. You were chosen as “Servant Leaders” because you manifest the capability of leadership through service. I am greatly honored to be part of this vibrant club and I am looking forward to a memorable Rotary Year ahead. The club guided by experienced senior Rotarians and supported by energetic youngsters, I am sure the year under your leadership will achieve all the goals which are already set by you and your team.

With this year's RI theme, " Create Hope in the World," we have an amazing opportunity to serve our society through humanitarian service. Let's give it our best, create strategies to retain membership, inject Vitamin “C”- CARE, CONCERN AND COOPERATION. This is the best formula that strengthens bonds and inspire our teams of volunteers to share responsibilities and complete service projects

As your newly appointed Assistant Governor, our District has already given me an opportunity for new experiences, to meet new people, walk side by side and to have some fun along the way. I look forward to more discoveries with you, my fellow Rotarians. I’ll make myself available to Madam President and your Board and to each and every one of you if you have any questions that I may be able to assist with. Together, I believe we can generate new ideas that we may use to continue and improve this great organization.

Let us challenge ourselves to make a real difference this Rotary Year 2023-24 and create memories of pride and joy!

Together we can, Together we shine.

Rtn. Kalpana Devi Piya Shrestha
Assistant Governor 2023-24
Zone - 15
RI District 3292, Nepal – Bhutan



Message from President 2023-24



I am proud to be a Rotarian! I am most honored and humbled to be elected as a President for Rota Year 2023-24 of the Rotary Club of Yala. I would like to express my sincere thanks to all fellow Rotarians of Rotary Club of Yala for their confidence and trust on me giving the chance to being as a President for Rota Year 2023-24. With the help and support of my Board members, fellow Club members, and specially my husband PP Rtn Deepak K. Shrestha along with Anns, Rotaract and Interacts we will be able to the polish the image of RC of Yala to new heights. Once again, I promise I will do my best to meet the challenge.

Our club has been built on a strong leadership foundation, and I am fortunate to have members those are fully committed to the Rotary motto "Service Above Self" and continues to go the extra mile in building the vibrant club, and carrying out the many worthwhile projects that we undertake for the benefit of our community.

I have been attached to this club since the date of the Charter as a guest of charter member my brother Rtn. Kiran Shrestha dai. I although, never have imagined that I would be taking the responsibility of a Rotary Club of Yala as a President.

Let me take this opportunity to congratulate Immediate Past President Rtn. Gautam Shrestha and his Board for a very successful Rota year 2022-23. During his year, IPP Gautam Shrestha guided me as his successor throughout his tenure, and I thank him, and caution him that I will be depending on his continued support throughout my tenure so as

all directors and members of our vibrant club "RC Yala"

Rotary International President Rtn. Gordon R. McNally, revealed the theme for Rota Year 2023-24 as "Create Hope in the World ". In doing so, I'm sure he had in mind the shared commitment of every Rotarian to provide "Service Above Self." We also commit to create a new beginning in the World, joining hands with the RI President.

There are many needy people throughout our community whose only hope will come from Rotary. Let us all commit here and be ready to make their lives better in any way that we can. As Rotarian, it will not be good enough to give only what we have left over or what we can spare, but we must truly give of ourselves with new vigor in support of the ideals of Rotary. Let us lead the way as Rotary shares its legacy of "Service Above Self". We will be fortified with the necessary knowledge, skills and tools " Create Hope in the World "!!

Finally, I promise to do my best to ensure that good work continues and in better ways, needless to say, I need support from everyone to make 2023-24 a great Rotary year for all of us.

With warm regards and best wishes to you all.

Jay Rotary!!!

Rtn Shobha D. Shrestha
President 2023-24
Rotary Club of Yala
RI District 3292

ROTARY INTERNATIONAL
RI DISTRICT 3292

Message from President 2022-23



Dear Fellow Rotarians,

As my term as President of Rotary Club of Yala comes to a close, I want to express my sincere gratitude for having the privilege of serving you and the community in this role. It has been an honor to work alongside such dedicated and extraordinary Rotarians. I am proud of everything we have accomplished together.

During the Rota Year 2022-23, we've made a positive impact in our community and beyond, through our various service projects and initiatives. Whether it was supporting local community schools, organizing health camps and retinoblastoma awareness programs, building toilets under Rotary Community School Toilet Projects, supporting needy patients, supporting environment through tree seedling plantations & temple cleaning, handing over of PCR Extraction Kits, Oxygen Concentrator, Digital Video Colposcopy machine, wheelchairs or whether volunteering our time and resources to those in need, we have demonstrated what it truly means to embody Rotary mission of "Service Above Self".

Fellowship programs are a key part of Rotary's mission to build connections and promote understanding among people from different backgrounds. I am happy to share that we had programs such as Annual Picnic, New Year Celebrations, Women's Day Celebration, Holi Festival Celebrations, Chartered Day Celebration, Heritage Tour, Hiking Programs, happy hours and meetings conducted outside of regular club venues.

throughout the year. Your contributions, regardless of their size, have made a significant difference in the lives of others and have strengthened our Club's reputation as a force for good. More than 150+ activities happened during these 365 days and that was certainly a big achievement for the Rotary Club of Yala.

As I pass the torch to our new President, I am confident that we will continue to thrive and achieve greater goals. I urge you to continue supporting and collaborating with our new leadership, and to stay actively involved in the Club's activities and initiatives. As Immediate Past President, I want to offer you my support and guidance whenever you need it. Leading a Rotary Club is a challenging and rewarding experience, and I am confident that you're up for the task. Remember to stay focused on our Club's mission of "Service Above Self", and to work closely with our members to achieve our shared goals.

During my term, we achieved many successes, but there is always more work to be done. I hope you will continue to build on our past accomplishments and explore new avenues for service. Together, I know we can make a difference in our community and beyond.

Thank you again for an incredible year, and I look forward to continuing to serve alongside you as a Proud Rotarian.

Yours in Rotary,

Gautam Shrestha
President 2022-23



आयन्स नायोया नुग र्वं

स्वसा दच्छि बिइन ! ओ हो थव नायो या भाला दिकेगु ई नं गोन्हू हे म्वाल । अय्क लुमका ह्यां, अजु चाः, नीनिदं तक्क मस्तय् तः आखः ब्वंकेगु ज्या त्वताः छँ व मचा यातः इ बिइगु बिचाःया दशुइ छक्कलं आयन्स या नायोया भालाकाय् तः इनाप याःगु इलय् जिं भिन्याकः बिचायाना । रोटरीया तःजि लजि थुपिं हनेबहःपिं आयन्स तताकेहें पिनिगु न्ह्योने ज्यु धाये तः गुलि मछिइगु आ तक्क नं लुमं जिं, ज्यु धाय् कि लिचिले धका जिगु नुगले धौ बजि वाः, वहे इले छँया थःमिजं भाजुं नं हःपा बियादीगु अले आयन्स तताकेहें पिन्सं नापं तिबः बियादीया थव भाला कोबिइत अपुल । उबलेहें आइन्सतेनं धाःगु बचं "Only a life lived for other is a life worthwhile" जिगु नुगले न्हापांनीसें दुथ्याःगु कथं ज्यु धया । गथे याःसा, छु याःसा लिपा जितः व रोटरी यातः अवगाल वइ मखु धका च्यू ताः तयाः थव भाला पूमवतले जिगु नुगः थासे मलाः, यक्को पासा, आयन्स तता केहें पिनिगु सहलहपाखें आः वयाः लिफ स्वय् बले गुलि तक्क नं यानाःगु ज्या तालय् ह्य् फूगु हे थें च्वं । बिशेष यानां भुतु च्याकेतः करपिनिगु ख्वा स्वय्माःपिं सुनानं छुं छकु नय्गु बिइ हइलाः धका भूयालं स्वया च्वनिपिं असहाय मस्त व बुढाबुढि पिं, अथेहे ल्हाः तुति मदु पिं च्वनिगु अनाथालय वनां नसा चुलाके खडगु ज्यां यक्को यक्को मन थाहां वः । थाय् थासे याःगु देगलय् वनां थःगु चःति दान् यानां सुचुपिचु याय्गु ज्यां जितः व्युगु सन्तुष्टि तःजिकहे जूगु ताय्का च्वनाःगु दु । थाय्थासे चोड्गु स्कुलय् व्वनामि मस्तयतः सफु चोसा बिइगु ज्या व न्हिने बजि नकेगु ज्या अथे हे धेवा पुले मफया बोने च्वय् मखं पिन्त ग्वाःलि याय् खनां तसक्कं दुनुगलं निसें लसता वःगु तायका । थव दच्छि दुने यक्को न्हुपिं पासा पिं नं दत । यक्कु नापं स्वापु क्वातुल व यक्को सिनं थःयातः म्हसीकुगु खं नं जिं बांलाक चाल, लिसें जिके च्युता दुगु जुल । खुसि छीगुज्या क्वचायवं ततां ल्वःमंकीगु मनया स्वभाव त्वःतेगु भूवलय् माःबलय् मामाःकथं ग्वाःहालि यानादीपिं आयन्स तताकेहें पिं, राटेरियन भाजु मय्जु पिं, रोट्राक्ट किजाकेहेंपिनितः जिं धाय् हे मा कि छिकपिनिगु ग्वाहालिं मदूगु खःसा यानागु फुक्क ज्या पूवंक जुई धयागु मनय् मदु । वय्कःपिं दक्को सितः दुनुगलं निसे शुभाय् देछाना । थव हे भूवलय् रोटरी क्लवय यलय यायो भाजु गौतम श्रेष्ठ यात वय्कः नं बियाःदीगु भलसा, हःपा व तिबः यात शुभाय् देछाना । फुसां मफुसां छिकपिनि न्ह्योने

Message from Ann President 2023-24



On behalf of the Anns Group of Yala, I congratulate President Rtn Shobha Devi Shrestha and the new Board of Directors for the Rota Year 2023-24. Under President Shrestha's leadership, the new board will undoubtedly achieve significant milestones in maintaining our club's active legacy.

As members of the Anns Group of Yala, we are eager to provide unwavering support and help accomplish the club's goals. I sincerely thank all my fellow Anns for entrusting me with the honor and responsibility of the presidency.

Gyanu Nakarmi
President - Anns Group of Yala

नेवा भाय् छ्यलेतः तिबः बिया दीम्ह धुब मान प्रधान भाजुयात नं शुभाय् । थव हे इले २०२३-२४ रोटरी दँया नायो या भाला कोबिया दिइ त्यम्हः मय्जु शोभादेवी श्रेष्ठ व वयकः यात हःपा बियादीपिं बोर्ड या दुजःपिं अले थव आयन्स पुचःया नायो भाला लः ल्हानां कयादी त्योम्हः मय्जु ज्ञानु भाउजु यात यक्को शुभाय् व सफलताया मनंतुना । सुनानं हुइ मफैगु पलाः ख्वँय् त्वताः भाइगु बिश्वास नं प्वंडका च्वना । आयन्स पुचःया नायो या भाला जितः बियाः सेवा यायेगु जस बियादीगुलिं तःधंगु भाग्य भाःपिया । थुकिया नितिं नं रोटरी क्लब यल व आयन्स पुचःयात दुनुगलं निसैंया सुवाः व भिन्तुना देछाना ।

पुर्ण लक्ष्मी श्रेष्ठ
आयन्सया नायो

२०२२-२३

रोटरी क्लब अफ यल, आयन्स पुचः



CREATE HOPE
in the WORLD



Message from Rotaract President 2023-24



Rtn. Shobha Devi Shrestha
President RY 2023/24
Rotary Club of Yala

I am writing on behalf of the Rotaract Club of Yala to extend my heartfelt congratulations and best wishes to all the Rotarians and Anns of the Rotary Club of Yala. Your remarkable work and tireless efforts have left a lasting impact on our community, and we are grateful for your dedication and leadership.

As a member of the Yala family, I have been privileged to witness firsthand the positive impact of Rotaract on personal and professional growth. It has been a place where ideas, knowledge, and skills are shared and put into action through Rotary service. Through the power of teamwork, we have learned to make a meaningful impact on our community and develop our personal skills. This would not have been possible without the assistance and guidance of the Rotary Club of Yala.

Rotary Club of Yala has been a valuable partner in service of the Rotaract Club of Yala. I have had the pleasure of meeting and learning from several inspiring entrepreneurs, company owners, and

dedicated community members through the Rotary Club of Yala. The warm and welcoming atmosphere of Rotary has enabled me to develop my communication and social skills while feeling like a respected and valued member of the community. Hence, I would like to thank all the Board of Directors and President Rtn. Gautam Shrestha for being able to create an environment that fosters both personal and professional growth, and encourages innovation. With your support we are able to flourish and thrive in such a supportive and dynamic environment.

As we look towards the future, I extend my best wishes to the incoming President Rtn. Shobha Devi Shrestha and the new board for their upcoming tenure in 2023/24. Your leadership and dedication will undoubtedly continue to inspire and make a positive impact on our community.

Yours in Rotaract
Rtr. Swostika Shakya
President-Elect 2022/23
Rotaract Club of Yala

EDITORIAL



पौजवाया चवसाँ पिज्वगु खँपु ।

ज्वजलप्पा !

अी रोटरी यलया जः पिन्सँ लुमंकेहेमाःगु खँ खः रोटरी यल पलिस्था ज्वगु इलय रोटरी यल यातः मुँज्या ज्वीगु इलय नेपाल भाषायातः हे छेलिगु खँ जुयाहे जःपिं दुचायकीगु ज्यानं जूगु खः, रोटरी यलया नाँ तयगु अफुवःलय “रोटरी क्लब यल” धका जक तयगु जःदुने सहलह जूगु खयानँ तय मफुत थुकि रोटरी यल नापँ “पाटन” धका घाय्माःगु जुल, उबलया रोटरीया डिष्टकया दुजःपिं नापँ यक्कु हे खँ जूसँ अी जःपिन्सँ डिष्टकया जः पिन्त खँय् त्याकि मफुत, इमसँ नक्साय् “यल” धका चवयातःगु वयौं धैगु खँ जूबले जानं हे नक्साय् “यल” धका ब्वयाःतःगु अीसँ वयेनि मफुत, आः वया न्हूगु ब्वबस्थाँयानाँ तिनि थःगु भाषँ थःगु थाय्बाय्थानाँ नँ नक्साय्, गुगलमापय् व त्वा त्वालया बोर्डय् खने दत, थव अीगु हे नेवातय्या कुतलं जूगु खः । अथेन्तुं रोटरी क्लब यलय पाटन घानाँ तःगु यातः उबलय्या नायः रो. ई. सुरेन्द्र गोबिन्द जोशीजुं अमेरिकाया प्रिन्सिपल नापँ पौ चवया खँ ब्याकाः “पाटन” यातः चिकेगु ज्या जूगु खः । थुकिया नितिं वय्कःयातः शुभाय् बीमाः अीसँ ।

आवली अीगु क्लबय् नेवाभासँ मुँज्याय् ब्वःतिकाय्गुलिं बुलुं ठहो जुजुं वनाँ च्वंगु खनेदु । थव जूगुया हुनि धैगु नेवा भाय् थू, तर खँलहाय् गु बानि मरुपिं नं दू, थुकियातः धाय् थाय् मरु सा गुलिं भाय्लहाय् सयानाँ नेवाभाय् लहाय् बले ववःय्चाय् किपिनं दु थें च्वं, अले खसभाषँ लहाय् बलय तहो जूगु ताय्किपिं नं दूगु ताय्का । लुमंके बहःजु अी नेवाभाय्या पुलाँपिं भाय्या मतिलाँ यानाँदीपिन्सँ जान जमन जूगु भाय् अनहे लहाय् मदय्का बिल धका ख्वया सरकार नापँ ल्वालवाहे थःगु जीवन पानाँ वंपिंदु । आतकनं सरकारी ज्याकुथि नेवाः भाषँ खँलहाय् मरुसाँनं, अी रोटरी यलया जँ पिन्सँ हलिया नाँदंगु रोटरी इन्टरनेशनलय् नाँ दुथ्याका थःगु भाषँ खँलहाय् खंकाःतय् फूगु अी नेवा तय्गु निति तहोगु गौरब याय् मा । अकिं अीसँ थुगु थासँ नेवा भाषँहे खँ लहाय्, मसःपिन्तनं सयकेत कुतः याय्, अीगु वापौले नं नेवाः भाषँ हे मुँज्याया कोछिना खँ पिथनि, अीगु भाय्यात खँलहानाँ थपु याय् ।

शुभाय्

रो. धुबमान प्रधान



CREATE HOPE
in the WORLD



We wish all the best to
ROTARY CLUB OF YALA
on the occasion of its
27th Anniversary

**PURE NATURAL HONEY
ORIGINAL TASTE**

*Different kind of
pure honey available at*

**N. STONE BEE CONCERN
STONE BEE CONCERN**

Satdobato, Lalitpur, Nepal.
email: purehoney44@hotmail.com
purehoney444@gmail.com
Tel: 977-1-5523853
Cell: 9851064935



everyinches

📍 Satdobato-15, Lalitpur, Nepal

☎ 9851151362, 9813854593

✉ everyinches.nepal@gmail.com

ROTARY CLUB OF YALA

Board of Directors Rotary Year 2023-24



President
Rtn. Shobha Devi Shrestha



Immediate Past President
Rtn. Gautam Shrestha



President Elect
Rtn. Dharmendra Raj Shakya



President Nominee
Rtn. Om Shanker Shrestha



Vice President
Rtn. Sworupa Shrestha



Secretary
Rtn. Sanjay Shrestha



Treasurer
Rtn. Om Krishna Shrestha



Director
Rtn. Manjari Tamrakar



Director
Rtn. Dr Dinesh Shrestha



Director
Rtn. Dr. Rabindra Roy



Director
Rtn. Kanti Shrestha



Director
Rtn. Twinkle Nyachhyon



Sergeant-at-Arms
Rtn. PP Kiran Shrestha



Editor
Rtn. PP Dhruva Man Pradhan



Club Trainer
Rtn. PP Dilendra Raj Shrestha



CREATE HOPE
in the WORLD

**ROTARY
CLUB OF YALA**
Members with Spouses



RTN. ANIL BAJRACHARYA

Classification: Geologist (2022-23), Buddhist Scholar-
Athropologist, Director UCMS, Kamaladi (R) Awas
Bhaisipati Block P House No 123, Lalitpur;
Cell: 9841204685, 015590813
Email: anilaryavajra@yahoo.com;
Spouse: SABITRI. B: Sep 25; W: March 30



RTN. AMRIT R. SHAKYA (PHF)

Classification: Gold Silver Handicrafts (1995-96), (O)
A4 Trade Concern, Hakhatole, Lalitpur 12; (R) Hakhatole,
Lalitpur 12; Email: shakyaamritraj@gmail.com;
Tel 5525949 (R) 5521558 (O) Cell: 9841295292;
Spouse: AJANTA. Ser: Dir, Tr, SA, VP;
B: Apr 6; W: Mangshir 22



RTN. BASANTA RAJ. SHRESTHA (PHF+1)

Classification: Computer Engineering (2007-08), (O)
ICIMOD, Dhapakhel, Lalitpur; (R) Dholahity-9, Sunakothi,
Lalitpur; Email: basanta.shrestha@icimod.org;
Tel 5572072 (R) 5003222 (O) Cell: 9801068733;
Spouse: MINU. Ser: Dir; B: Jun 30; W: Apr 16



RTN. ANJU SHRESTHA

Classification: Share Investor (2018-19)
New Baneshwor, Kathmandu. Tel: (R) 4466048
Cell: 9841383835
email: anjusth.prem@gmail.com
Spouse: PREM Ser: Dir B: 2 March W: 15 Falgun



RTN BEKHA KRISHNA SHRESTHA (PHF+1)

Classification: Metal Handicrafts (2010-11),; (R) Jhatapole,
Ward no. 16, House No. GA/412, Lalitpur; Email:
bekhas74@gmail.com; Tel 5534450 (R)
Cell: 9851138679; Spouse: SARASWOTI;
B: Jun 28; W: Falgun 1



RTN. DR. ANJU SHRESTHA,

Medical Doctor (2019-20), (O) NCHRC, Harisiddhi,
Lalitpur, (R) Kumaripati, Lalitpur, Email: anjushr2002@
yahoo.co.in, Cell: 9851010838, B:
Spouse: SUJIT GOPAL



RTN. BHUBANESHWOR PRASAD JOSHI

Classification: Auditing (2007-08),; (R) 25 Kwako, Lalitpur
11; Email: bhuban60@gmail.com; Tel 5535414 (R) Cell:
9851034467; Spouse: SUSHILA. Ser: Tr; B: Dec 12; W:
Baisakh 19



RTN. CHANDRA BAHADUR MAHARJAN (PHF)
Classification: Advocate (2014-15), (O) Jawalakhel-20, Lalitpur; (R) Jawalakhel-20, Lalitpur;
Email: advocatetchandrmb@gmail.com; Tel 5546415 (R)
Cell: 9851075231; Spouse: HIRASHOVA. Ser: Tr; Dir B: April 10; W: Baisakh 21



RTN. DHARMA R. SHILPAKAR
Classification: Travel Agency (1996-97); (R) DipabaliMarg, Satdobato 15/281, Lalitpur;
Email: dharmaratna_san@hotmail.com; Tel 5525386 (R)
Cell: 9851034318; Spouse: NIRMALA. Ser: Dir, JSec, SA; B: Aug 5; W: Jan 16



RTN. DEEPAK K. SHRESTHA (PHF+2)
Classification: Banking (2007-08), (O) Nepal Investment Bank Ltd., DurbarMarg, Kathmandu; (R) Chakupat, Ward No. 11, (oppMitra School), Lalitpur;
Email: deepakyala@gmail.com; Tel 5260488 (R) 4242530 (O) Cell: 9851119063; Spouse: Rtn. SHOBHA .Ser: Dir, Sec, VP, PE, P (2016-17); B: Jul 28; W: Feb 24



RTN. DHRUBA M. PRADHAN (PHF)
Classification: Accounting (Freelance Consultant) (1995-96); (R) Punbachhen, MangalBazar, Lalitpur; Email: dmpradhan@gmail.com; Tel 5421016 (R)
Cell: 9851032792; Spouse: MEENU. Ser: Dir, Sec, Tr, VP, P (2004-05); B: Aug 25; W: Apr 21



RTN. DEEPAK DAS TAMRAKAR (PHF)
Classification: Civil Engineer (2018-19)
Senior Hydropower Specialist in NEA Engineering Company Limited, Trade Tower, Thapathali. (R) Mount View Residency - II, Harisiddhi, Lalitpur - 28. Tel: (R) 5250740 (O) 5111024 Cell: 9851213335, 9841224835
email: deepak.tamrakar@gmail.com Ser: Dir B: 25 July W: 1 Magh Spouse: MANJAREE



RTN. DR. DINESH LAL SHRESTHA (PHF+2)
Classification: Disaster Management and Humanitarian Emergency Former Officer at UNHCR (R) The Comfort Housing, Thaiba; Email: shrestha.ds@gmail.com; Tel 5014808 (R) Cell: 9818143527; Spouse: MITA; B: Jul 30; W: Mar 12



RTN. DHARMENDRA RAJ SHAKYA (PHF)
Classification: Monitoring & Evaluation (2018-19)
(O) Street Child of Nepal, Sanepa.(R) Chakupat, Lalitpur-10 Tel: 5260776 (O) Cell: 9860802032
email: dhshakya2003@gmail.com Spouse: RATNA DEVI, Ser: Dir, Sec. B: Nov 2; W: 16 Magh



RTN. DILENDRA R. SHRESTHA (PHF+1)
Classification: Restaurant (1995-96), (R) Civil Homes, House No 54, Khumaltal Height, Lalitpur-15
Email: dilendras@gmail.com; Cell: 9851060654;
Spouse: BHABANI.
Ser: Sec, VP, P(1999-2000), ADS, DCh, DS, AG, DT, Ch. Coord, DG(2013-14); COL Rep. B: Sep 27; W: Feb 1



CREATE HOPE
in the WORLD



RTN. DR DIBESH KARMACHARYA

Classification: Bio Technologist (2022-23), Chairman and Executive Director, Center for Molecular Dynamics Nepal (CMDN) (O) Prasuti Griha Marg, Thapathali, Nepal; Email: dibesh@cmdn.org; Cell: 9851110329, 5352897, 5351590,5361652; Keltole, Kathmandu. B: Jun 18;



RTN. KANTI SHRESTHA

Classification: Home Maker (2022-23), Rose Village Housing No: A36, Balkot 2; Nepal; Email: kantishrestha1902@gmail.com; Cell: 9841069881; Spouse: Rtn. UPENDRA. B: Feb 19; W: Dec 1



RTN. GAUTAM SHRESTHA (PHF+1)

Classification: Software Architect (2016-17), (O) GAPSCO, Kupondol, Lalitpur; (R) Gairidhara, Kathmandu; Email: shresthagautam@gmail.com; Cell: 9851068909; Spouse: PRATHANA; Ser: Sec, Dir, PE, P B: Dec 1; W: Jan 29



RTN. KIRAN NATH SHRESTHA (PHF)

Classification: Forestry (1999-00), (O) Maxlee Traders Pvt. Ltd., Kopundole, Lalitpur; (R) Machaghaga Pulchowk Lalitpur; Email: shreskiran@gmail.com; Tel 5543266 (R) 5530337, 5541014, 016221876 (O) Cell: 9841329935; Spouse: MEENA. Ser: JSec, Sec, VP, P(2012-13), Dir; B: Nov 28; W: Falgun 26



RTN. JEETENDRA NAKARMI (PHF)

Classification: Handicraft (2018-19) Kuti Saugal - 11, Lalitpur. JN Enterprises Cell: 9849000900 email: jnakarmi56@gmail.com B: 8 Mangsir W: 1 Baisakh Spouse: GYANU



RTN. KIRAN SHRESTHA (PHF+2)

Classification: Publishing (1995-96), (O) Hand Made Souvenir Product, Lalitpur. (R) Moneyplant Namuna Basti, House No. 71, Khumaltar, Hattiban, Lalitpur 15. Email: kiranshrestha1959@gmail.com; Cell: 9851031220; Spouse: SRIJANA. Ser: E, Dir, Sec, VP, P (2007-08), DSch; B: Oct 15; W: Marga 15



RTN. JIBAN BAHADUR PRADHAN

Classification: Civil Engineer (Freelance consultant); (R) Kanibahal, Lalitpur-6; Email: jibanbpradhan@gmail.com Tel 5535679 (R) Cell: 9841348378; Spouse: KUMUD. Ser: Dir; B: Oct 14; W: Baisakh 27



RTN. LUCKY NYACHHYON PRADHAN

Classification: Management (2019-20), (O) Lucky Finance, Dhalko; Punarjeevan Hospital, Shankhamul, (R) Mount View Residency Lalitpur, Email: luckynyachhyonpradhan@gmail.com, Tel. 5250353 (R), Cell: 9841295379, Spouse: Dr. SUDARSHAN, B: Jan 25, W: Mangsir 12

HBL

Credit Card

BUY NOW, PAY BY INSTALLMENT

Convert your purchase through HBL Credit Card into EMI



*Conditions Apply

HBL



Himalayan Bank Ltd.

himal@himalayanbank.com | www.himalayanbank.com

Please Contact

Card and Digital Channel Business Development Department

Phone No.: 01-4245979, 4245980 | Viber: 9803560838 | Toll Free No: 16600112000

E-Mail: cardcenter@himalayanbank.com | Kamaladi, Kathmandu

QR SCAN
FOR MORE
DETAILS.



[himalayanbankltd](https://www.facebook.com/himalayanbankltd)

[@himalayanbanknp](https://twitter.com/himalayanbanknp)

[Himalayan Bank Ltd.](https://www.youtube.com/HimalayanBankLtd)

[Himalayan Bank \(Viber\)](https://www.viber.com/HimalayanBank)

“सुरक्षित भविष्यको लागि निवृत्तभरण र सञ्चय कोष”

कर्मचारी सञ्चय कोषबाट सञ्चयकर्ताहरूलाई आ.व. २०७९/०८० मा उपलब्ध सेवाहरू :

- (क) सञ्चय कोष र निवृत्तभरण कोष रकममा व्याज प्रदान : २०७९ श्रावण १ गते देखि ८:०० प्रतिशत
- (ख) मूनाफा प्रदान : सञ्चय कोषका सञ्चयकर्ता तथा निवृत्तभरण कोषका योगदानकर्तालाई आर्थिक वर्ष २०७८/७९ को शुरु मौज्जात रकममा १.२० प्रतिशत ।
- (ग) सापटी सुविधाहरू :
- विशेष सापटीमा : ब्याजदर ९.१० प्रतिशत,
 - सञ्चयकर्ता घर सापटी, शैक्षिक सापटी र घर मर्मत सापटीमा : ब्याजदर ९.७५ प्रतिशत,
 - सञ्चयकर्ता जग्गा खरिद सापटी र सरल चक्रकर्जा : ब्याजदर १०.२५ प्रतिशत,
- (घ) धितोमा आधारित कर्जाको ब्याज त्रैमासिक रुपमा कृत्रिनी गरी नियमित गर्ने सञ्चयकर्ताको हकमा सम्बन्धित त्रैमासमा तोकेको ब्याजमा ०.२५ प्रतिशतले रिबेट (छुट) दिने ।
- (ङ) सामाजिक सुरक्षा सुविधाहरू :
- दुर्घटना क्षतिपूर्ति : सेवाकालमा सञ्चयकर्ताको दुर्घटनामा परी मृत्यु भएमा वा पूर्ण अंगमंग भएमा रु २ लाख ।
 - काजकिरिया अनुदान योजना : सेवाकालमा सञ्चयकर्ताको मृत्यु भएमा रु.४० हजार ।
 - सञ्चयकर्ता स्वास्थ्योपचार योजना : सञ्चयकर्ता अस्पताल भर्ना भई उपचार गरेको साधारण रोगमा रु.१ लाख सम्म र घातक रोगमा रु.१० लाखसम्मको औषधोपचार खर्चको शोधभर्ना कोषबाट हुनेछ ।
 - सुत्केरी तथा शिशु स्याहार सुविधा : प्रति प्रसूति रु.७ हजार ५ सयका दरले बढीमा दुई पटक गरी रु.१५ हजार ।



कर्मचारी सञ्चय कोष
EMPLOYEES PROVIDENT FUND

पुल्चोक, ललितपुर ।

Website : www.epfnepal.com.np

Call center : 015970041



RTN. MANJAREE TAMRAKAR

Classification: Management (2019-20), (O) Biswo Niketan, Tripureswor, (R) Mount View Residency, Harisidhhi, Lalitpur; Email: manjareetamrakar@gmail.com, Tel 5250740 (R), Cell 9841248737, Spouse: DEEPAK, B: Magh 21, W: Magh 1



RTN. OM SHANKER SHRESTHA (PHF+1)

Classification: Accounting & Auditing. (2016-17), Registered Auditor (R) Gwarko Bafal -17, Lalitpur; Cell: 9841291142; Email: omshrestha4@gmail.com Spouse: RADHA; Ser: Dir,Sec, Tr. VP B: Nov 29; W: Ashadh 24



RTN. MOHAN BYANJANKAR

Classification: Choreographer (2018-19) Chyasal - 9, Lalitpur. Academy of Dance and Music Tel: (R) 5532446 Cell: 9841291385 email: thebyanjankar@gmail.com B: 13 April W: 7 Falgun Spouse: RITA



RTN. PADAM K. SHRESTHA (PHF)

Classification: Trekking (1995-96), (R) Indrayani, Balkhu, Sanepa, Lalitpur W. No. 2; Email: padams1617@gmail.com; Tel 5520466, 5526785 (R) Cell: 9851034857; Spouse: Rtn. URMILA S. Ser: Tr, Dir, B: Nov 23; W: Baisakh 16



RTN. NARAHARI DAS JOSHI (PHF+2)

Classification: Electrical Engineering (Freelance Consultant) (2001-02).; (R) Milijuli Shanti Chowk, New Baneshwor -34, Shanti Nagar, Kathmandu; Email: joshi_nd@hotmail.com; Tel 4621044 (R) Cell: 9851083344; Spouse: BINU. Ser: Dir, E, Sec, P(2010-11); B: Sep 18; W: Jan 12



RTN. PRAMOD S. PRADHAN (PHF+4)

Classification: Geo-informatics (1998-99), HN 701, Civil Homes, Sunakothe, Thecho, Lalitpur. Email: pramodssp@gmail.com; Tel 5574746 (R) Cell: 9851026566; Spouse: USHA. Ser: Dir, JSec, Sec, VP, P (2009-10), GSE Team Leader (2012) DCm, AG; B: Nov 6; W: Dec 24



RTN. OM KRISHNA SHRESTHA (PHF)

Classification: Human Resource Management (2016-17), (O) Pulchowk, Lalitpur; (R) Koteshwore, Kathmandu; Email: okshrestha2013@gmail.com; Tel 4600593 (R) 5010165 (O) Cell: 9851193777; Spouse: SUNMAYA; Ser: Dir, B: Dec 18; W: Magh 25



RTN. PREM KUMAR SHRESTHA

Classification: Banker (2018-19) Baneshwor, Kathmandu. Agricultural Development Bank Ltd. Tel: (O) 4222297 (R) 4466048 Cell: 9841202309 email: prem_sth@hotmail.com B: 19 Dec W: 15 Falgun Spouse: ANJU



CREATE HOPE
in the WORLD



RTN. PREM SINGH (PHF)

Classification: Bee Keeping Business (2002-03), (O) N. Stone Bee Concern, Sinchahity, Lalitpur, Nepal; (R) Sinchahity, Satdobato, Lalitpur, Ward no. 6. Lalitpur; Email: purehoney44@hotmail.com; Tel 5523853 (R) 5523853 (O) Cell: 9851064935; Spouse: DEENA. Ser: Dir, Tr, JSec, SA; B: Jun 17; W: Falgun 23



RTN. Col(retd) ER SANJAYA SHRESTHA,

Director: Nepal Cancer Hospital & Research Center (R) Mount View Residency Phase 2, Harisiddhi, Lalitpur Tel: 015251585 Cell: 9851195503 email:sanjayashrestha43@gmail.com B: 23 April W: 9th Baisakh Spouse: PURNA LAXMI



RTN. PRERANA JOSHI

Classification: Business (2018-19) (R) Dhobighat - 3, Lalitpur. (O) Kalpvriksha Company Pvt. Ltd. email: jjprena@gmail.com Tel: (O) 5529908 (R) 5153575 Cell: 9818136361 B: 18 April W: 11 July Spouse: MANISH JUNG



RTN. SARITA SHRESTHA (PHF)

Classification: M&E (2011-12),; (R) Jwagal, Lalitpur; Email: sarita.shrestha@gmail.com; Tel 5540551 (R) Cell: 9851082223; Spouse: Rtn. Dr. CHANDRA LAL. Ser: Tr, Sec; VP, PE, P B: Dec 1; W: Feb 17



RTN. RAJENDRA M. SHRESTHA (PHF)

Classification: Taxation (2005-06),; (R) Chakupat, KholchaPokharitole, Lalitpur, H. No. 31, Ward No 11; Email:shrestharajendra123@gmail.com; Tel 5260309 (R) Cell: 9808980129; Spouse: RAMUNA. Ser: Sec, Dir, VP, P (2014-15); B: Apr 19; W: Falgun 8



RTN. SANGITA AMATYA SHRESTHA,

Classification: Trainer/Policy Maker, Health and Safety Manager (2019-20), Everest Fashion (O) Khumaltar Height-15, Lalitpur @ Khumaltar Height-15, Lalitpur, Email: sangita@everestfashion.com, Tel: 5540963 @ 5525187 (O), Cell: 9841592647, Spouse: MAHESWOR, B: Nov 19, W: Baisakh 26



RTN. DR. RABINDRA ROY

Classification : NRM & Climate Change Researcher (2022-23), (O) Nepalensis Initiative (R) Nhooja Chhen, Bhaisepati, LMC -25. Email: rsroy81@gmail.com Cell: 9851149635, Spouse: SHOMINA B: May 7; W: Feb 18



RTN. DR. SANTOSH SHAKYA (PHF)

Classification: Endocrinology (2011-12),; (R) Thado Dhunga, Jhamsikhel, Lalitpur-3; Email: drshakyap@yahoo.com; Tel 5536776 (R) 5530203 (O) Cell: 9801030370, 9851030370; B: Dec 26



RTN. SHAILENDRA BAJRACHARYA (PHF+1)

Classification: Jewelry Business (2001-02), (O) Menak Jewellery ,Pulchowk, Lalitpur; (R) Pulchowk, Lalitpur; Email: sailendrabajracharya@hotmail.com; Tel 5529464 (R) 5529464 (O) Cell: 9851012613; Spouse: RASMILA. Ser: Dir; B: Aug 6; W: Mar 5



RTN. SURENDRA G. JOSHI (PHF+7)PHS

Classification: Civil Engineering (Freelance Consultant) (1995-96), (R) Morning glory, Shree Tole 2556, Man Bhawan, Lalitpur 5; Email: ersgjoshi@gmail.com; Tel 5534328, 5534491 (R) Cell: 9860999303; Spouse: BADRILAXMI. Ser: Dir, P (2001-02) AG, SA; B: Feb 20; W: Falgun 19



RTN. SHOBHA DEVI SHRESTHA (PHF)

Classification: (Retd) Business Information System, Smart Telecom P. Ltd., Kumaripati, Lalitpur; (R) Chakupat, Lalitpur; Email: shobhadevishrestha@gmail.com; Tel 5260488 (R) 5008588 (O) Cell: 9841343792; 9611020010 Spouse: Rtn. DEEPAK; Ser: Sec, E; VP B: May 25; W: Falgun 12.



RTN. SURENDRA G. SHRESTHA (PHF+1)

Classification: Wooden Furniture Manufacturing (2004-05), (O) Shree MahalaxmiKasthaUdyog, Satdobato, Lalitpur, Nepal; (R) Satdobato, Lalitpur; Email: surendraniru_shrestha@hotmail.com; Tel 5551425, 5151800 (R) Cell: 9841566522; Spouse: NIRMALA. Ser: Tr, Dir, Sec, SA, PE, P; B: Falgun 19; W: Baisakh 12



RTN. SUBHAKAR BAIDYA (PHF)

Classification : Program Development and Management (1998-99), (R) Shubhakuti, Sapa Jarhun, Satdobato, Lalitpur-14; Email: subharenu@hotmail.com; Tel 5151544 (R) Cell: 9818569595; Spouse: RENU. Ser: Dir, J.Sec; PE; B: Mar 14; W: Falgun 21



RTN. DR. SUDIP SHRESTHA (PHF)

Classification: Oncology (O) Nepal Cancer Hospital and Research Center, (R) Khumaltar Height, Lalitpur; Email: sudipsh@hotmail.com; Tel 5533493, 5535513 (R) Cell: 9801141004; Spouse: Rtn. SWORUPA; B: Nov 7; W: Feb 2



RTN. DR. SUMITRA MANANDHAR GURUNG (PHF+1)

Classification: Microfinance (2006-07), (O) Swabalamban Labhubitta Bittiya Sanstha; (R) 598 Kimdol Marga, Kathmandu, Nepal; Email: sumitramgurung@gmail.com; Tel 4275198 (R) Cell: 9851041075; Spouse: Dr. CHANDRA (Late). Ser: Dir;VP,PE,P (2021-22) B: Oct 25; W: May 25



RTN. SUSHIL BAJRACHARYA

Classification: Insurance (2007-08), (R) BodhigramTole, Satdobato, Lalitpur 17, Nepal; Email: sushil.ujjwol@gmail.com; Tel 5201591 (R) Cell: 9851051758; Spouse: UJJWOL. Ser: E, Sec, VP, P; B: Sep 28; W: Mar 9



CREATE HOPE
in the WORLD



RTN. SWORUPA SHRESTHA (PHF+1)
Classification: Social Worker/Director, (O) Nepal Cancer Hospital & Research Center, Harisiddhi, Lalitpur; (R) Khumaltar Height, Lalitpur; Email:sworupaz@hotmail.com; Tel 5533493(R) 5251495/96/98/99 (O) Cell:9851041004; Spouse: Rtn. Dr. SUDIP; Ser: Dir,VP
B: Nov 26; W: Feb 2



RTN. TWINKLE RAJBHANDARY NYACHHYON,
Classification: Business Development Head, (2019-20) Director Marketing, Aviotrace Nepal, Instructor, Airport Ground Handling, School of Technology, Mid Baneshwor President at Vintage and Classic wheels Nepal (2022-2023), Co founder at Twinkles @ Mount View Residency, Lalipur, Email: 2iinkle@gmail.com, mamumayaa@gmail.com Cell: 9851057684, DOB Sep 11



RTN. URMILA SHRESTHA (PHF+1)
Classification: Microfinance (1995-96), (O) MahilaSahayatra Microfinance BittiyaSanstha, Sanepa, Lalitpur; (R) Indrayani, Balkhu, Sanepa, Lalitpur W. No. 2, Lalitpur; Email: urmilashrestha09@gmail.com; Cell: 9851021539; Spouse: Rtn. PADAM . Ser: Dir, JSec, VP, P(2006-07), DCh; SA
B: Apr 12; W: Baisakh 16



RTN. Prof. DAVID GELLNER
Honorary Member
Classification: Anthropology (O) School of Anthropology and Museum Ethnography, 51 Banbury Rd. Oxford OX2 6P; Spouse: DOLORES MARTINEZ

ROTARY CLUB OF YALA

Club ID : : 31764
Chartered : : 28.06.1996
No. of Members : : 51 (Active – 50; Honorary – 1)
Meeting Day : : Friday
Meeting Time : : 5:30 PM
Venue : : Bagaicha Restaurant, Jawalakhel
Area Code : : 01
Rotaract : : 1
Interact Club : : 1
RCC : : 4
PHF : : 21
MPHF : : 14, Major Donor Level 1
PHS Member : : 2

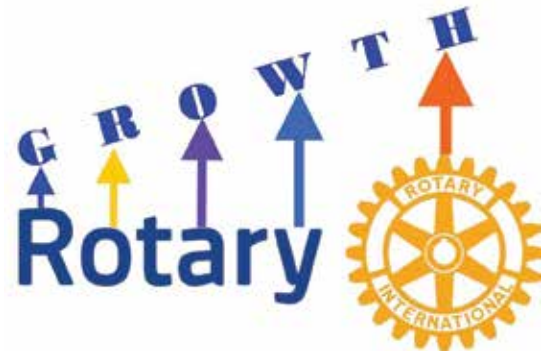

ROTARY CLUB OF YALA ANNS EXECUTIVE COMMITTEE 2023/24



Secretary
Rtn. MANJARI TAMRAKAR



President
GYANU NAKARMI



Treasurer
RATNA DEVI SHAKYA



INTERACT CLUB OF YALA BOARD OF DIRECTORS 2023/24



President
NISCHAL DHAKAL



IP President
AASHIKA PUN MAGAR



Secretary
SUMANA BAJRACHARYA



Treasurer
RAJSHREE TANDUKAR

Sister Club Agreement between the Rotary Club of Yala (Nepal) and the Rotary Club of Jindalee (Brisbane, Australia)

February 14, 2023

The Rotary Club of Yala signed sister club agreement with the Rotary Club of Jindalee, Brisbane (Australia) during rotary meeting of RC Jindalee. On behalf of the Rotary Club of Yala, Rtn Dr Dibesh Karmacharya exchanged MOU and flags with the President of RC Jindalee Rtn Irene Lategan. These two sister rotary clubs have been collaborating for many years now, and they have successfully implemented a global grant helping a municipality hospital in the Kathmandu valley during COVID-19 pandemic. Further collaboration in the fields of health, education and community development have been discussed and pledged.



The President of RC Jindalee Rtn Irene Lategan and Representative Rtn Dr Dibesh Karmacharya from the RC of Yala exchanging club flags during Sister Club Agreement signing ceremony



Rtn Dr Dibesh Karmacharya from the RC of Yala visiting RC Jindalee (Australia)

Engaging RC Yala in Godawari-Phulchowki Forests Conservation Area

“...living in harmony with nature”



Dr. Dinesh Lal Shrestha, Director,
TRF (2023-24)

Dr. Rabindra Roy, Director, Service
Projects (2023-24)

Background: A forest ecosystem offers numerous ecological services to the communities living in the area, its surroundings and often far beyond, and is critical to human welfare and survival. Besides, forest resources significantly contribute to nation’s economy directly and indirectly, provided that they are properly managed.

Highlands around Kathmandu valley embrace lush forest covers, providing the valley with fertile land, fresh water, captivating natural beauty and favorable climate. This perfect condition for habitation has attracted people to settle in this valley since historical times. In due course, it has gradually become the center for major economic activities, social and cultural development, and political power. However, in the recent past, the valley has seen unprecedented rapid urbanization and, as a consequence, exerted a huge pressure on its environment. This, regrettably, unregulated growth is pushing the urban sprawl further into the foothills, raising concerns over potential damage to the existing forests surrounding the valley and their biodiversity.

Among four prominent hills that surround the Kathmandu valley Phulchowki, located in the South-East corner, is the highest hill with an altitude of 2,765 m above msl. It covers forest area of 2,128.88 ha (2,078.35 ha in Lalitpur and 50.53 ha in Kavrepalanchowk districts). Phulchowki watershed with its rich biodiversity is an important lifeline for the inhabitants of the Kathmandu valley and directly supports those living in Lalitpur and some parts of Kavrepalanchowk district. This ecosystem is habitat for countless species of plants, animals and microbial life, provides fresh water, wood, biomass and herbs, balances local and micro climate by moderating temperature and promoting rain, serves as a body for carbon sink, and offers spiritual/cultural, recreational, research and educational opportunities. All these services have contributed towards improving

well-being of the people living in the area and its proximity.

Phulchowki watershed remains a biologically productive ecosystem. However, with the increased human actions, impacts of global climate change and other external stressors, one is not sure how far it will continue to be resilient to such shocks. Given the importance of this ecosystem and to mitigate potential shocks it may have to face due to those stressors, the Government of Nepal has recently declared national forests in the Phulchowki hill as **Godawari-Phulchowki Forests Conservation Area** (Ref: Govt. of Nepal Gazette no. 72-16-5 issued on 22 June 2022), which must be considered as timely and essential for well-being of the population depending on it.





CREATE HOPE
in the WORLD



Rationale: While inclusion of Phulchowki watershed as one of the forest conservation areas in Nepal is an important step of the government to protect and regulate the natural resources, successful implementation of such plan will not be fully realized unless there is a strong and meaningful participation of all stakeholders, including local communities living in the area. It is in this context that some members of the Rotary Club of Yala with a long and varied experience in different professions have taken an initiative, purely as a philanthropic mission, to set up a platform to complement the efforts of the government, the community living in the area and other stakeholders by offering its supports and services.

Overall Goal: The overall goal of the proposed platform, Phulchowki Area Conservation Trust (PACT), under the auspices of the RC Yala, is to contribute in improving and strengthening the knowledge-base and collaborate with stakeholders to implement activities that would help to protect and conserve the Phulchowki watershed and its bio-diversity, and enhancing the productivity of its ecosystem services as well as welfare of the population living in the area. This platform aims to serve as a credible entity and play a catalytic role towards conservation and development of the Phulchowki hill.

RC Yala endeavors to implement its activities in collaboration with the Ministry of Forests and Environment and concern departments (Federal Government), including Division Forest Offices/Sub-Division Forest Offices (Provincial Government), as well as with municipality and ward offices (Local Government), and community forestry user groups. Partnerships will be sought with entities like NTNC (National Trust for Nature Conservation), ICIMOD (International Centre for Integrated Mountain Development), NAST (Nepal Academy of Science

and Technology), academia and civil societies who have a stake on the conservation and development of the Phulchowki area and have considerable knowledge and resources to contribute towards those overarching goals.

Scopes of Work: Following are the primary areas PACT has identified for rendering its services.

1. Research and Information Management – Our focus in this area will be on elements of Phulchowki ecosystem services and their optimum uses, impacts of human activities and climate change, and environmentally-friendly appropriate technologies, services and green agenda. Academia shall be engaged to undertake researches through post-graduate students as well as other dedicated research activities. A repository of information/data related to Phulchowki hill conservation and development will be maintained and shared for public consumption on open-source platforms.
2. Public Awareness and Educational Outreach – We will disseminate and instill facts and useful knowledge to the local communities, who are dependent on Phulchowki watershed, about the importance of forest ecosystem services, conservation goals and sustainable development of the area. This will be achieved through conducting Phulchowki talk series/seminars/workshops, organization of field visits and in-situ demonstrations, engaging with educational institutions in the area, and participating in relevant programs/events, social media and publications.
3. Protection and Conservation of Forest Ecosystem – While responsibilities under this domain primarily fall under the scope of forestry offices and the community forest user groups, we will make available services of Rotary members to share their professional expertise and knowledge for execution of annual programs and activities endorsed by the Ministry of Forests and Environment both at Federal and Provincial levels and their Departments

देशको माया ADBL को छत्र छायाँ...



फर्माउनुस् विदेशमा, पैसा उब्जा स्वदेशमा

- एकै अनलाइन निवेदनबाट
- बचत खाता
- मेरो सेयर खाता
- डिम्याट खाता
- CRN नम्बर तथा अनेक थप सुविधा



विदेशबाटै पनि खाता खोल्न,
सेयर आवेदन दिन तथा
रकम जम्मा गर्न सकिने ।

श्रम स्वीकृति लिई वैदेशिक रोजगारीमा रहेका
नेपाली नागरिकका लागि आरक्षण गरिएको
साधारण सेयर आवेदन दिन तथा अधिकतम व्याज
प्राप्त गर्ने गरी बचत गर्न सकिने ।



मुख्य कार्यालय:
रामराष्ट्रपाथ, काठमाडौं,
फोन नं. ०१-४२५२३५९, ०१-४२६२६२०,
फ्याक्स: ०१-४२६२२९९,
www.adbl.gov.np



SWIFT: ADBLNPKA

सम्पूर्ण बैकिङ्ग सुविधा सहितको तपाईं हामी घर आँगनको बैंक

Always standby at your service...



OUR SERVICES



Mountain Flight



Rescue Operation



Adventure Flight



Customized Flight



Pilgrimage / Holy Tour



Aerial Photography / Filming



Long Line Rescue



Sling Operation

Simrik Air is the leading helicopter company in Nepal with superior track record in high altitude services, recreational / holy tours and adventure tourism.

Fly to your destination in the comfort and safety of Simrik Air's latest helicopters.



Simrik Air Pvt. Ltd.

Head Office

P.O.Box: 10288, Subidhanagar, Teenkune, Kathmandu, Nepal

Tel: +977 1 4155341 / 42 / 43 Fax: +977 1 4155345 / 46

Kathmandu Airport : Tel : +977 1 4483233

Pokhara Airport : Tel: 061 467544 Mobile: 9851010694/9851203498/9858020684

Lukla Airport : Mobile: 98510 10695 | 9801123824 / 825

Marketing

Tel: +977 1 4155340

Mobile: +977 98510 10696

+977 98510 10697 / 98512 03493

Email: info@simrikair.com.np

Website: www.simrikair.com

and Divisions respectively.

4. Community Empowerment and Livelihoods – Community empowerment and provision of livelihood opportunities to the local communities are indispensable to attain sustainable development and conservation goals. As such initiatives will be taken to imparting skills and knowledge in health, hygiene and waste management, natural resources management and uses, disaster preparedness and response, agro-forestry based cottage industries for income generation, and providing opportunities for employments through village tourism/home stay as well as eco-tourism, such as nature walk, hiking, adventure sports, star gazing and educational excursion in Phulchowki area.

5. Cultural and Recreational Services – Phulchowki, like other three hills (Shivapuri, Nagarjun and Chandragiri) around Kathmandu valley, is revered as a sacred place by both Hindus and Buddhists. Several important religious and cultural activities are held in the area every year, and the communities from nearby old settlements like Badegaon, Thaiba, Harishiddi, Luvu, Thashi, and Lele observe particular festivals dedicated to Phulchowki goddess, located on the top of the hill. Besides, there are many places of worship/monuments located in different parts of the Phulchowki hill, which are visited by thousands of devotees every year. The area is also a popular destination for picnickers and people seeking recreations. Given this, we will seek to coordinate and collaborate with local authorities and communities to facilitate such activities in an organized and regulated manner with the principle of “do no harm” to the nature and local socio-cultural practices.

Organization and Ways Forward: Given the nature of the tasks, RC Yala has committed itself to engage in this initiative as a flagship project for a minimum of five years. Accordingly, initial preparations are being made by forming two teams: one focusing on internal arrangements/procedures, including fund raising, resource management and communication with other Rotary Clubs at district 3292 and beyond, and another one to reaching out to external entities

for collaborations and partnerships. Consultations with key external entities have started in last couple of months at different levels and so far the responses have been encouraging for RC Yala’s engagement in this noble cause with the motto of ‘living in harmony with nature’, which cuts across several focus areas of the Rotary movement and perfectly fits with its mission, i.e., take actions to create a lasting change – across the globe, in our communities, and in ourselves.

As we move along the consultation process in the course of coming months, we shall identify key issues/activities that come under five broad scopes outlined above, and will be further harmonized and prioritized in line with the plans of the stakeholders implementing projects in Godawari-Phulchowki forests conservation area and the communities surrounding it. The activities thus set out will then be transformed into work plans with clear indicators for implementation, resource mobilization and measurement of outcomes.





CREATE HOPE
in the WORLD

"Dream of Clean Nepal"

Whether in temples, at homes, offices or any public places, the responsibility is on us to keep these places clean. I agree that many of us do keep our homes neat and clean but throw garbage at public lanes from their windows. And we teach our children to use the dustbin in our house and school but we throw the banana skins and prasad covers in the temple corridor. How can we expect the temple authorities to clean these dirt every time? Is it not our duty to keep these heritage sites clean? According to me this will not come by teaching or punishing but it must come by self-realizing. But I do not know when this self-realization will come . If we request a group of people to join for temple cleaning program then only 20 percent will join but at the same time if we ask people to join us for the party or a movie then 90 percent will join. This is why I wonder where this self-realization is, it is still somewhere forcefully hidden in inside us.

Well, these days we all must have visited our neighboring country India and Temples in INDIA, where thousands of people and devotees visit in a day but still that place are neat and clean. It's all because of the strong team with strong authority to look after it and clean it every now and then. If Temples in INDIA can be neat and clean then why can't our Temple be clean?. We can see flower stalls, plastic and other puja items on a large scale near the temple inside and out. They try to earn as much as they can from the visitors and after buying they drop those items in the temple premises which finally becomes waste. All we need is to purify our mindset, which is very important.

This is why I am Twinkle Nyachhyon , a proud member of Rotary Club of Yala , leading TEMPLE CLEANING PROGRAM since 2021 . We have started this movement as a Rotarian, and now we are growing big, collaborating with Vintage and Classic Wheels Nepal, a proud young and enthusiastic team to save Vintage and cars in Nepal, and with a great support from Lalitpur Municipality . Till date we successfully cleaned up number of temples, with a Motto " Save Heritage and Dream of Clean Nepal " as we all know Nepal is full of Temples , so Dream of Clean Temple is equal to Dream of Clean Nepal . I urge everyone to join us in this cleaning moment if you all are a real devotee of GOD. We do not need to show off with expensive gold silver plate or expensive stuffs to go to temple, we can worship GOD in the temple with empty handed and if possible just pick up few garbage and shift it into the dustbin. We must keep our holy Temples neat and clean as much as possible.

Twinkle Nyachhyon
Membership – Chair
2023-2024



WASH IN PHULCHOWKI SCHOOL



Pramod Pradhan

Yala WASH programs

Rotary Club of Yala has steered WASH programs in public schools and local communities since its inception in 1996. Nepal has been facing a major challenge in fulfilling every child's right to water, sanitation and hygiene education. Though Nepal is blessed with huge amount of fresh water, the government has been unable to safeguard the wellbeing of children due to the difficult terrain and poor access to sparsely distributed settlements. There are hundreds of thousands of children who lack proper access to drinking water, sanitation facilities and hygiene education.

A number of international partners (RI District 2700 Fukuoka, Rotary Club of Wrexham-UK, Rotary Club of Jindalee-Brisbane, RI District 9630 Brisbane-Australia) have supported RC Yala's several WASH programs in schools and communities. These programs encompassed wells construction, rain water harvesting and ground recharge, drinking water purification, toilets construction, sanitary and menstrual hygiene, and WASH education.

Phulchowki School

Phulchowki Higher Secondary School, a public-community school, is located at Thaiba of Godawari Municipality in Lalitpur District. It has four buildings within its premise of 22 Ropani land. The main building with 30 rooms is awaiting renovation, since Great Earthquake of 2015. The classes are run in the remaining limited spaces for Early Child Development to Bachelor's level with a total population of 65 teachers and 1300 students including 780 females. This has severely impacted the limited WASH facilities. During class-breaks the students, especially girls, have to wait in long queues to relieve themselves forcing them to miss lessons after the breaks.

Based on the request by the School Management and field assessment of the current WASH situation, RC Yala decided to build new toilets with 20-25 urinals and 6-7 cubicles for defecation. The installation of these will help school management to maintain academic and administrative discipline as well as clean and hygienic environment.





CREATE HOPE
in the WORLD



Moreover, this project will improve health, foster learning and enable children to participate as agents of change for their siblings and parents and the community at large. This project will contribute to Rotary's effort in making sure that every child receives the benefits of WASH in Schools.

Objective of Yala WASH Programs

The objective of the Yala WASH programs is to realize five key benefits of WASH in Schools

1. Healthy & protective school environment minimizing risk of disease, abuse & exclusion;
2. Brings pride and commitment among children by enabling them to become agents of change;
3. Investment in the health and well-being of future generations;
4. Promotes gender equity leading to higher girls' school attendance & retention;
5. Discourages habit of defecation in open

Cooperation and Resources

It's quite encouraging to mention that the Godawari Municipality, Sister Club RC Jindalee and Yala Rotarians instantaneously committed to raise funds for needed resources to implement this WASH program in the Phulchowki School.

plumbing-flooring, and improve sanitation and menstrual hygiene (installing sanitary dispenser and incinerator system and sanitary pads). Out of these facilities, only toilets are being constructed at present due to limited resources and the remaining facilities will be added later when funds are available. The initial budget of NRS 60 Lakhs (~USD 46,000) has been halved to NPR 30 Lakhs (~USD 23,000) that includes NPR 7 Lakhs from Godawari Municipality, NPR 8 Lakhs from RC Jindalee and RID 9630 Brisbane District Grant, and NPR 15 Lakhs from RC Yala's project fund.

Compliments

The author takes liberty in extending hearty thanks and gratitude to Ward Chairman Dipendra Shrestha of Godawari Municipality, Int'l Director Soo Choong of RC Jindalee, ICS Chair of RID 3960 Brisbane, Principal Gopal Pandey of Phulchowki Secondary School & staff & students and Architect Sangeet Poudel & his team. It's also cheering to extend heartfelt thanks to all Yala Rotarians, Anns, Rotractors and Interactors who have diligently contributed in realising this project. Special thanks are due to Yala members: PP Surendra Gopal Shrestha, Rtn. Dr. Dinesh Lal Shrestha, Treasurer Om Krishna Shrestha, Rtn Om Shanker Shrestha, Rtn Kanti Shrestha and President Gautam Shrestha.

The program targets to construct separate toilets for boys and girls, install water tanks &

Livelihoods and Distribution of Majhi Social Group in Khotang and Okhaldhunga Districts of Koshi Province



Rabindra Roy, PhD;
Director, Service Projects
(2023-24), RC Yala

Majhi: Living with the Saptakoshi River Nepal is considered to be the treasure-trove of globally significant biological and cultural diversity. The Indigenous Peoples (Adibasi Janajati/Indigenous Nationalities) of Nepal, almost all live close to nature and depend on natural resources for their survival. Their cultural and socio-political values are instrumental to the protection and sustainable management of natural resources. The recent development practices, population pressure and growing urbanization have posed threats to both the culture and nature of indigenous peoples. As a result, the Indigenous peoples have been displaced from their traditional territories. They, no longer, enjoy customary rights over their natural resources. The discrimination and marginalization of indigenous peoples have resulted in their impoverishment. Consequently, many indigenous peoples have already lost their cultures and natural environments .

Nepal is the home of 59 indigenous nationalities. These nationalities are distributed in different regions of Nepal; 18 in the Mountain (Himalaya) region, 24 in the Hilly region, 6 in the Inner Taraai region and 11 in the Taraai region. Among them, the Majhi social groups are largely distributed in the inner Taraai region of Nepal .

Majhi social groups are one of the indigenous peoples (Adibasi Janajati) of Nepal. Their ancestral territories had embedded relationships with the Saptakoshi River (Indrawati, SunKoshi, TamaKoshi, Likhu,

Dudhkoshi, Arun, and Tamor) that flow through hilly and inner Taraai regions of Nepal . Tributaries of Saptakoshi include Indrawati of Sindhupalchok; Tamakoshi of Ramechhap and Dolakha; Likhu (Varun) of Ramechhap and Okhaldunga; Dudhkoshi of Okhaldhunga, Khotang, and Sankhuwasabha; Arun of Bhojpur, Samkhuwasabha and Dhankuta; Tamor of Dhankuta, Panchthar and Tehrathum. Majhi migrated to Makwanpur from Sindhupalchok and Kavre; to Sindhuli from Kavre, Ramechhap, and Okhaldhunga; to Udaypur from Ramechhap, Okhaldhunga, and Khotang; and to Arun and Tamor from Dudhkoshi, Tamakoshi, and Sunkoshi. Majhi in other places migrated from these seven rivers. According to the 2011 Census, the total population of the Majhi is 83,727 and the majority of them live in the hill and the lowland (the Taraai) of the central and the eastern regions of Nepal .

This study was carried out from 26 to March 04, 2022 under the DCRL project/GEF/MoFE/DoFSC.

Roy, R. (2004). Protecting What's Ours: Indigenous People's Initiatives to Biodiversity Conservation in Nepal (A case study of Lapcha Community from Ilam District of East Nepal). Kathmandu: Nepal Federation of Indigenous Nationalities (NEFIN).

NFDIN (2003) National Foundation for Development of Indigenous Nationalities - An Introduction, Kathmandu.

Doody, T.M., Cuddy, S.M., and Bhatta LD (2016). Connecting flow and ecology in Nepal: current state of knowledge for the Koshi Basin. Sustainable Development Investment Portfolio (SDIP) project. CSIRO, Australia. 194 pages.

CBS, 2012. National Population and Housing Census 2011 (National Report). Kathmandu: Government of Nepal, National Planning Commission, Central Bureau of Statistics.





CREATE HOPE
in the WORLD

During the Shah-Rana regime in Nepal, Majhi were recognized for their traditional services i.e. ferrying. They were granted Kipat land (communal ownership of land) in their ancestral territories, which helped them to continue their customary ways of life. The Kipat was granted for their services to ferrying people and to take government officials and postmen across different Ghaat/s (river banks) even during the rainy season. After the political changes in 1950s, the state denied their traditional rights of fishing and boating which fundamentally altered their socio-economic conditions and dispossessed them from their lands and embedded relationship with the local rivers. The arrivals of socially dominant groups in Majhi villages-the hill “high” caste Hindus in particular, led to the increased landlessness among Majhi to such an extent that many Majhi migrated to other places in search of daily livelihoods. The cultural assimilative policies imposed by the Panchayat (1960 to 1990) regime were further instrumental in marginalizing Majhi. Majhi became landless .

In the past, these areas were inflicted with virulent malaria and only Majhi social group could live and survive there. Majhi were the first cultivators of the plain lands in these river basins. Majhi social groups have their own distinct culture and customary ways of life and speak, Majhi kura , a spoken language belonging to the Indo-Aryan family. They are ‘nature worshippers’ and also known as ‘tantric’ religion. However, many Majhi practice syncretic religious practices both ‘tantric’ and Hindu religions in the changing context.

Majhi have closely connected with the Koshi River culturally and religiously. Nowadays, they perform Koshi puja every year on Tuesday of third week of Falgun. They also do ancestral rites in the Koshi River. Majhi living along these rivers also consider themselves as Bote. Moreover, the former chairman of the Nepal Majhi Upliftment Association Dhan Bahadur Majhi says: ‘Majhi are animist. They worship jungle, rivers, hills, mountains, and air through tantric means, and they believe that tantric power preserves humans, animals, and agricultural land.’ Due to influence of Hinduism, some Majhi perform Hindu rituals. Now some are also attracted to Christianity, especially the poor Majhi .



Ferrying and Economy

In the rural sphere of Nepalese community, Majhi social groups are synonymously known as ‘Majhi, Machha (fish) and Paani (water).’ To elaborate it, Majhi social groups’ customary life directly depends on the rivers. Subsistence farming, fishing, boat making and helping people to cross the rivers in ferries have been their primary occupation. In the past, people and villagers used to pay a fee called khewa to Majhi for their services of crossing local people across the river in their boats. Villagers residing around the rivers would give them grains yearly in the form of dhungepathi. Hence, this form of reciprocal relationship ensured a stable source of income and means of livelihoods to the Majhi social groups. But, the construction of bridges (both concrete and suspension), Majhi lost their traditional occupation of ferrying.

Majhi use net and hooks to fish, but people from other social groups began to collect fish using electric current and chemicals, so there is decreasing the quantity of fish in the rivers. In this way, Majhi have been gradually detaching from fishing. Moreover, construction of small, medium and big dams on the river to generate electricity from hydropower further obstruct the movement of fish and their growth rate. Thus, they have been compelled to do cultivation and cattle raising in whatever small landholdings they possess.



Agriculture production is not enough to feed their children and other family members throughout the year; only sufficient for three to six months. Food security is one of the prominent problem of Majhi. Hence, they choose foreign employment as a migrant worker to the Gulf countries as the alternative livelihoods options and skilled and unskilled construction workers in urban areas in Kathmandu before leaving to third countries as the migrant workers. While working in Kathmandu, Majhi youth

Rai, J. and Majhi, H. (2014). Majhi of Nepal. Kirtipur, Kathmandu: Central Department of Sociology/Anthropology, (CDSA), Tribhuvan University (TU).
https://en.wikipedia.org/wiki/Majhi_language (accessed on 20 March 2022)
Rai, J. and Majhi, H. (2014). Majhi of Nepal. Kirtipur, Kathmandu: Central Department of Sociology/Anthropology, (CDSA), Tribhuvan University (TU).

make passport as a part of preparing to go to the foreign countries and explore appropriate manpower companies and/or consultancies.

The majority of Majhi are live in below the poverty line. Especially Majhi women specialize in making high-quality Marcha (yeast cakes for making beer). Majhi people, who have been engaged to help people safely cross rivers from many generations, are now become one of the marginalized social groups and excluded indigenous nationalities in Nepal. Majhi, as the other indigenous and marginalized social groups in Nepal, are, at present, struggling to continue and to preserve their culture and identity and reclaiming their sovereign indigenous rights.

Distribution of Majhi in Khotang and Okhaldhunga Districts

The Majhi social groups are distributed in the confluence of Dudhkoshi and Sunkoshi at the boundary between Khotang and Okhaldhunga districts in the eastern part of Nepal. Both districts lie under the Koshi Province. This study found that Majhi social groups are living in two Palikas of Khotang district namely Rawa Beshi Rural Municipality (three settlement of Majhi) and Halesi Tuwachung Municipality (two settlement of Majhi). In Okhaldhunga districts, they are distributed in two

Palikas Chisankhugadhi Rural Municipality (two settlement of Majhi) and Siddhicharan Municipality (one settlement of Majhi).

Majhi settlements in Khotang District

Majhi social groups are distributed in five settlements in Khotang district; three settlements namely Majhi Gaun, Bhaludhunga and Hattisar in Rawa Beshi Rural Municipality, ward no-3, Lamidanda and two settlements viz. Ghopataar and Majhi Basti in Halesi Tuwachung Municipality, ward no-4 Badahare and ward no-1, Jayaramghaat respectively. The field study found that total 128 Majhi households spread over five settlements. Majhi Gaun accounts higher number of households i.e. 64 whereas Majhi Basti (Jayaramghaat) has only 8 households. All settlements are nearby and/or along with the Dudhkoshi River and altitude ranges 427m to 640m (Table 1).



Table 1: Majhi Settlement in Khotang district

| Palikas | Ward | Settlement Name | HH No. | HH No. | Coordinate (UTM) | | Altitude |
|-------------------------------|-------------|-----------------|-------------|--------|------------------|------------|------------|
| | | | | | X | Y | |
| Rawa Beshi Rural Municipality | Lamidanda-3 | Majhi Gaun | 1 | 64 | 466765 | 3015853640 | |
| | | Bhaludhunga | 2 | 15 | 464989 | 3015177534 | |
| | | Hattitar | 3 | 9 | 462924 | 3013592459 | |
| Halesi Tuwachung Municipality | Badahare-4 | Ghopataar | 4 | 32 | 455485 | 3010518427 | |
| | | Jayaramghaat-1 | Majhi Basti | 5 | 8 | 448092 | 3005897429 |

Source: Field Study, 2022

According to vice-chairperson of the Nepal Majhi Upliftment Association, district chapter, Khotang, around 10-12 Majhi households in Majhi Gau are going to be denuded due to the 635 MW Dudhkoshi storage hydroelectric project and he stressed that they still need external supports to make Majhi people’s livelihoods more comfortable.

Majhi settlements in Okhaldhunga District

Majhi social groups are spread over three settlements in Okhaldhunga district; two settlements namely Bhoje and Majhitaar in Chisankhugadhi Rural Municipality, ward no-6, Bhadaure and ward-1, Kuibhir respectively.

Similarly, Mulghaat, ward no-1 Taluwa in Siddhicharan Municipality. The field study revealed that total 66 Majhi households distributed in three settlements. Majhitaar has higher number of households i.e. 43 whereas Mulghaat accounts 6 households. All settlements are nearby and/or along with the Dudhkoshi River and altitude ranges 431m to 682m (Table 2).



CREATE HOPE
in the WORLD

Table 2: Majhi Settlement in Okhaldhunga district

| Palikas | Ward | Settlement Name | HH No | Coordinate (UTM) | | Altitude |
|-----------------------------------|------------|-----------------|-------|------------------|--------|------------|
| | | | | X | Y | |
| Chisankhugadhi Rural Municipality | Bhadaure-6 | Bhoje | 1 | 17 | 463561 | 3014929442 |
| | Kuibhir-1 | Majhitaar | 2 | 43 | 467874 | 3021479682 |
| Siddhicharan Municipality | Taluwa-1 | Mulghaat | 3 | 6 | 459175 | 3011631431 |

Source: Field Study, 2022

Conclusions

Availability of water: a better livelihoods option

Water scarcity is a prominent problem of Majhi settlements even though they are living along the Dudhkoshi river. Availability of enough water in the Majhi settlements is the primary crux for the better livelihoods options to the Majhi social groups. Thus, the study team recommends lifting water from Dudhkoshi should be put into first priority before intervening any livelihoods development activities and that would be a ‘value for money.’

Once addressing problem of water scarcity, there are many avenues to enhancing livelihoods options for Majhi social groups such as fishing in eco-friendly water conservation ponds; vegetable (both seasonal and off-seasonal) farming; and black pig and local chicken farming.

Collection and Knowledge Center (CKC): A marketing strategy

Most of the Majhi settlements are connected with all-weather roads thus accessibility of market will not be a big problems. However,

the study team recommends the collective marketing mechanism should be established through the Collection and Knowledge Center (CKC) that enhance the bargaining power of any products of Majhi social groups. This will provide rationale cost to the primary producers and save their time to deal with the market and/or going to the market to sell the product in small quantity.

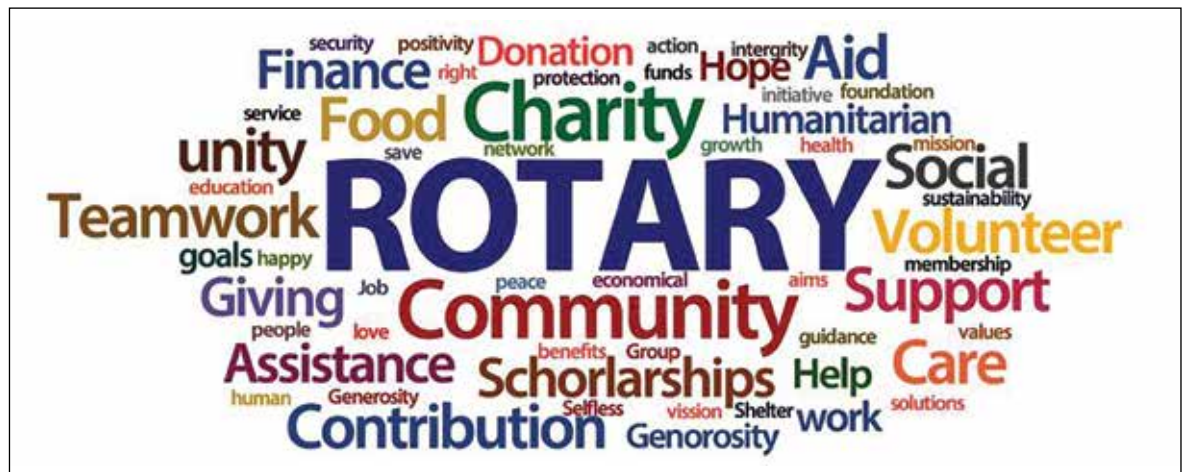



All Your Healthcare Needs Under a Single Roof

Sowa Healthcare is a modern multispecialty center equipped with advanced technologies and uncompromised services.



Health Care Packages



In-house Pathology & Pharmacy



Home Service



Diagnostic & Imaging Services



Dermatology & Cosmetic Procedure



Dental Service



Sowa Healthcare Center, Ekantakuna, Lalitpur



Valley Ornaments Pvt. Ltd.

Sharemarket Complex-16

Putalisadak, Kathmandu

The Exclusive Ornaments of your own choice.



We deal in precious, semi precious stones, gold and silver ornaments

Contact : 015331438 (Shop), 5549162 (Res.)

valleyornamentspvt.ltd@gmail.com

Hearty Congratulations!!!

Rotary Club of Yala

on the occasion of its 27th Anniversary



महालक्ष्मी विकास बैंक लि.
Mahalaxmi Bikas Bank Ltd.

(नेपाल राष्ट्र बैंकबाट "अ" वर्गको राष्ट्रियस्तरको इजाजत प्राप्त संस्था)



सबल बैंक, सफल सहकार्य



Think before you print.



ROTARY CLUB OF YALA

Rotary Year 2022-23 Activities

Club Administration

- June 11 2022 The Review and Planning Workshop of RC Yala for 2022/23 was drafted at the Club Assembly. The current and incoming Chairs of Standing Committees led various working groups.
- June 18 2022: Rotary Club of Yala has lifted the title of Rotary Inter Club Futsal Tournament. RC Yala defeated RC Kritipur 8-1 in the final match played at Matshya Recreation Center on Saturday 18th June 2022. The champions received Gold medal while first runner got Silver medal. Rotary Club of Yala, Rotary Club of Kritipur, Rotary Club of Balaju and Rotary Club of Kathmandu Height was participated in this event.
- July 2 2022 DG Jitendra Bahadur Rajbhandary installed Rtn Gautam Shrestha as the 26th President of RC Yala for 2022-23 by putting collar pin and handing over charter certificate of the Club, gavel and gong. DG Jitendra B Rajbhandary administered the oath to newly installed President Rtn Gautam Shrestha.
- October 14, 2022: Maha Puja Documentary Presented
- December 30, 2022: 6 Months Status Report Presented by Rtn Gautam Shrestha
- February 24, 2023: Joint Meeting with Anns, Rotaract, and Interact
- Classification Talk and In-house Speaker
 - o July 8 2022: Rtn Dr Rabindra Roy
 - o August 19 2022: Rtn Kanti Shrestha
 - o September 9 2022: Rtn Dr Sumitra Manandhar Gurung
- o December 2, 2022: MyRotary Experience Training & Sharing by Rtn Gautam Shrestha
- o December 23, 2022: Classification Talk Program by Dr Dibesh Karmacharya
- o February 17, 2023: Stress Management by Rtn Dr Sudarshan Narsingh Pradhan
- o April 28, 2023: "HAPPY FAMILY" by Rtn Shailendra Bajracharya
- o May 26 2023: Discussion on GG Application Template by Pramod Pradhan
- Guest Speaker
 - o Recycle for the future: Kushal Harjani (22nd July 2022)
 - o Osteoporosis : Dr Rupesh K Vaidya (5th August 2022)
 - o Retinoblastoma: Dr Purnima Rajkarnikar Sthapit (2nd September 2022)
 - o Chiropractic: Dr Yojana Shahi (23rd September 2022)
 - o Talk Program on Nepal Sambhat Calendar by Er Lava Lal Pradhan (21 October)
 - o Supporting the Environment: Role of Rotary & Rotarian by Rtn Dinesh Manandhar (4 November)
 - o Stock Market by Ajay Singh Thapa: (27 January)
 - o "Pearlies are more precious than diamonds" by Dr Rita Singh (3 February)
 - o Nepali Movie and Music by Mr Prakash Sayami during joint meeting with RC Patan East (3 March)
 - o "NEPAL, NEWAR AND NEPAL BHASA – THE SCIENCE BEHIND LEGENDS" by Prof Dr Govinda Bol Shrestha during NRCL Meeting(24 March)
 - o Vajra & Ghanta by Samjwal Bajracharya (21 April)
 - o "The Journey of Sur-Sudha" by Surendra Shrestha(19 May)
- Club Assemblies
 - o 1st Club Assembly : June 11 2022
 - o 2nd Club Assembly : July 15 2022
 - o 3rd Club Assembly : November 18, 2022
 - o 4th Club Assembly & DG Visit : November 25 2022
 - o 5th Club Assembly : May 5 2023
 - o 6th Club Assembly Review Meeting : June 2 2023





CREATE HOPE
in the WORLD

- Board Meetings
- 1st Board Meeting hosted by Rtn Om Krishna Shrestha (July 16)
- 2nd Board Meeting hosted by Rtn Dharmendra Shakya (August 20)
- 3rd Board Meeting hosted by Rtn Sanjaya Shrestha (September 10)
- 4th Board Meeting hosted by Rtn Twinkle Nyachhyon (October 30)
- 5th Board Meeting hosted by Rtn Sworupa Shrestha (November 21)
- 6th Board Meeting hosted by Rtn Deepak Das Tamrakar (December 24)
- 7th Board Meeting hosted by Rtn Dr Sumitra Manandhar Gurung (January 14)
- 8th Board Meeting hosted by Rtn Jeetendra Nakarmi (February 25)
- 9th Board Meeting hosted by Rtn Shailendra Bajracharya (March 11)
- 10th Board Meeting hosted by Rtn Surendra Govind Joshi (April 7)
- 11th Board Meeting hosted by Rtn Lucky Nyachhyon Pradhan (May 16)
- Joint Board Meeting hosted by Rtn Gautam Shrestha, Rtn Shobha Shrestha, Rtn Om Shanker Shrestha and Rtn Surendra Gopal Shrestha (June)
- Happy Hours, Fellowship, Picninc & Hiking
- 2nd July 2022 Installation Program Fellowship



- 26th August 2022 Happy Hour
- 30th September 2022 Dashain Celebration
- 12th November 2022 Switzerland Park (Indra Daha) Picnic
- 25th November 2022 DG Visit Fellowship
- 14th January 2023 Chitlang Hiking and Fellowship
- 6th March 2023 Holi Festival Celebration @ Purna Museum Resort
- 10th March 2023 Women's Day Celebration
- 14th April 2023 New Year Celebrations (Picnic @ Kageshwori Resort)
- 15th April 2023 Phulchowki Hiking
- 19th May 2023 Fellowship after Sur-Sudha
- Memorandum of Understandings
- Sister Club Agreement with RC Madras on 14th September 2022
- MOU between Rtn Sushil Bajracharya & RC Yala on Endowment Fund "Chandra Muni Fund for Matya Health Camp" on 1st October 2022
- MOU with SOWA HealthCare & DENI on 16th November 2022
- Sister Club Agreement with RC Jindalee, Brisbane, Australia on 14th February 2023



Membership

- Inducted 4 new members Dr Rabindra Roy, Dr Dibesh Karmacharya, Kanti Shrestha and Anil Bajracharya.

The Rotary Foundation

- Following members contributed to TRF this Rota Year
- PP Rtn Surendra Govind Joshi PHF + PHS USD 1,500
- President Rtn Gautam Shrestha PHF USD 1,000
- Secretary Rtn Lucky Nyachhyon Pradhan PHF USD 1,000
- Rtn Dr Dinesh Lal Shrestha PHF USD 500
- USD 25 by all 55 members

Public Image

- July 2 2022 Published Souvenir on 26th Anniversary; it was unveiled by DG Jitendra Bahadur Rajbhandary, on the club installation day.
- Widely distributed Rotary publicity materials
- Rotary T-shirt and Caps
- Annual Souvenir to School, College, Libraries and Partner association
- Celebrate important and dedicated days to enhance public image
- Visible participation in temple cleaning, mataya program, Diabetes Walkathon, heritage tour, etc



- wearing T-shirt and Caps with Rotary Logo.
- Encourage to plant fruit tree seedling at community schools
- Maintain, update and publish club website, social media, media, GML and Monthly News Letter
- Maintained and updated website www.rotaryclubofyala.org.np after each activities
- Likewise maintained and updated social media, and media regularly.
- Published activities report in Governor Monthly Letter (GML)
- Published and Distributed Monthly Bulletin "GAAN"
- Published and Distributed Presidential Monthly Reports
- Sharing Rotary Information and Knowledge to Non-Rotarians during Retinoblastoma Awareness Program

Participation in District Events

- April 8-9 2022 PE Rtn Gautam Shrestha and upcoming AG Rtn Deepak Kumar Shrestha attended the President-Elects Training Seminar program held at Hotel Pokhara Grande.
- May 21 2022 PP Rtn Deepak Kumar Shrestha, PP Surendra Gopal Shrestha, Rtn Twinkle Nyachhon, Rtn Lucky Nyachhon Pradhan, Rtn Anju Shrestha, Rtn Sanjaya Shrestha, and prospect member Dr Rabindra Roy, attended District Training Assembly at DAV School, Jawalakhel, Lalitpur, Nepal. PDG Rtn Dilendra Raj Shrestha from RC Yala, was the one of the trainer during this seminar
- May 22 2022 PP Rtn Kiran Shrestha, PP Rtn Deepak Kumar Shrestha, Rtn Sworupa Shrestha, and Rtn Om Shanker Shrestha, attended Grant Management Seminar at Shankar Hotel, Lazimpat, Kathmandu. PDG Rtn



- Dilendra Raj Shrestha from RC Yala, was the one of the trainer during this seminar.
- June 25 2022 PDG Rtn Dilendra Raj Shrestha, PP Rtn Sarita Shrestha, President Rtn Dr Sumitra Manandhar Gurung and Rtn Twinkle Nyachhon participated District Awards Ceremony at Yak & Yeti Hotel. Rotary club of Yala bagged 3 awards and 2 individual recognition in Rotary District Awards & Recognition 2021-22.
- July 1 2022 9 members (PDG Dilendra Raj Shrestha, Rtn Bhabani Shrestha, Rtn Surendra Joshi, Ann Badri Laxmi Joshi, Rtn Deepak K Shrestha, Rtn Shobha Shrestha, Rtn Sarita Shrestha, Rtn Bekha Krishna Shrestha, and Rtn Gautam Shrestha) participated in the Installation Ceremony of District Governor Rtn Jitendra Bahadur Rajbhandari (2022-23) of RI District 3292 Nepal-Bhutan, in 1st July 2022, at Soaltee Hotel, Kathmandu Nepal.
- Membership and Public Image Seminar : 5 Rotarians from Rotary Club of Yala participated District membership and public image seminar on 6th August 2022 at Aloft, Thamel. PDG Rtn Dilendra Raj Shrestha from RC Yala, was the one of the trainer during membership seminar and President Rtn Gautam Shrestha along with AG Rtn Deepak Kumar Shrestha, PE Rtn Shobha Shrestha, and Public Image Chair Rtn Anju Shrestha attended this seminar.
- Sister Club Agreement Signing Ceremony: Sister Club Agreement Signing Ceremony between Rotary District 3292 Nepal & Bhutan and Rotary District 3232 Chennai, India held at Hyatt Place Kathmandu yesterday 14th September 2022. A total of 23 Clubs signed the agreement with our Chennai counterpart. Additionally 14 more clubs of Pokhara is expected to sign this alliance on 15th September 2022.





CREATE HOPE
in the WORLD



- RIDE Felicitation and Basic Education & Literacy: On Friday 23rd September, in presence of RI Director Elect Rtn Aniruddha Roy Chowdhury, who is also the Secretary General of Rotary India Literacy Mission graced the event at the Hyatt Place Hotel, Kathmandu. Incidentally, RIDE Rtn Aniruddha was the last DG of RID 3290 (of which Nepal was a part until 30th June 2008). During the program RIDE Rtn Aniruddha Roy Chowdhury was also felicitated by Council of Governors. President Rtn Gautam Shrestha participated this event and Rotary Club of Yala was one of the host club for this event.
- Felicitation Program of RI President Jennifer E. Jones (December 6 2022): PDG Dilendra Raj Shrestha, Ann Bhabani Shrestha, PP Rtn Deepak Kumar Shrestha and PE Rtn Shobha Shrestha attended the program.
- 15th District Conference was held from 17th to 18th March 2023 at Gokarna Forest Resort.



- PDG Dilendra Raj Shrestha, President Rtn Gautam Shrestha, PP Rtn Narhari Das Joshi, PP Rtn Deepak Kumar Shrestha, PP Surendra Gopal Shrestha, PP Rtn Sarita Shrestha and PE Rtn Shoba Devi Shrestha were participated in the conference.
- President Elect Training Seminar 2023-24: PE Rtn Shobha Shrestha and upcoming AG Rtn Sarita Shrestha attended the program held at Chitwan on 31st March and 1st April 2023.



- Create Hope in the World: Rotary District Training Assembly: On 6th May 2023, PE Rtn Shobha Shrestha, PP Rtn Sarita Shrestha, TRF Chair Elect Rtn Dr Dinesh Lal Shrestha and Public Image Chair Elect Rtn Kanti Shrestha attended the program organized by RI District 3292 at Little Angle School, Hattiban, Lalitpur.
- Grant Management Seminar 2023: PP Rtn Pramod Sagar Pradhan, PP Rtn Sarita Shrestha and PE Rtn Shobha Devi Shrestha attended the event on 7th May 2023



Rotary Year 2022-23 Service Project Activities

Flagship Project “Temple Run”

Devotee believe Temple is the house of God though we know God lives everywhere and in everything still Temple is the place devoted to worship of God, which dedicated to religious and spiritual activities including prayer, meditation, sacrifice and worship such place should be always kept clean and hygiene

for its devotees, therefore looking at the need of cleaning Temple we Rotary Club of Yala decided to take this Temple cleaning as one of our flagship project. For Rotary, it is important to engage and make public aware of what it does in the local communities. Below is a list of activities taking place this Rota Year:

| Sno | Location | Month | Service Partners |
|-----|---------------------------------|-----------|--|
| 1 | Banglamukhi Temple | September | Rotary Club of Yala, Anns Group, Rotaract Club of Yala, Interact Club of Yala, and Sankhamul Mahila Samiti |
| 2 | Mahalaxmasthan | April | Rotary Club of Yala, Anns Group, and Vintage & Classic Wheels Nepal |
| 3 | Machindra Nath Chariot Premises | May | Rotary Club of Yala and Vintage & Classics Wheels Nepal |



Digital Video Colposcopy Machine Handover

Nepal Cancer Relief Society (NCRS), Lalitpur District Branch has been providing services related to cancer since last 2 decade. In view of the current need related to cancer test NCRS was looking for modern machines. On August 17 2023, President of Rotary Club of Yala Rtn Gautam Shrestha handed over Digital Video Colposcopy machine to the Chairman of NCRS Mr. Shailendra Lal Pradhan. The Digital Video Colposcopy system is a powerful high definition camera and imaging module used for clinical examinations of the cervix, vulva and vagina. A team of skilled doctors and skilled technicians from Nepal Cancer Hospital and Research Center (NCHRC) will available for assist to use of this machine. Special thanks to Rtn Surendra Govind Joshi for the financial support worth Rs 2.5 lac for Digital Colposcopy machine.



PCR Extraction Kits Handover to Nepal Korea Friendship Municipality Hospital

Rotary Club of Yala handed over PCR Extraction Kits amount worth Rs 1,80,000 to Nepal Korea Friendship Municipality Hospital, Thimi on September 20, 2022. The amount is left over from the Global Grant Project (No. GG2118291) miscellaneous expenses item.



Healthy Smiles for All: Free Dental Health Camp

| Sno | Location | Month | Beneficiary | Partner |
|-----|--|----------|-------------|--|
| 1 | Shree Navajyoti Secondary School, Godawari | May | 200 | Rotary Club of Yala, Interact Club of Yala & Ora Dental Clinic |
| 2 | agriti Academy, Koteshwor | December | 547 | Rotary Club of Yala, Bhujju Everest Dental Clinic |
| 3 | Kot Danda Health Post Godawari | October | 100 | Rotary Club of Yala, SOWA Healthcare Center |





CREATE HOPE
in the WORLD

Signature Project: CANCER CARE FOR ALL: EMPOWERING LIVES THROUGH FREE TREATMENT, SUPPORT AND AWARENESS

"Cancer Care for All: Empowering Lives through Free Treatment, Support, and Education" has been a signature project of the Rotary Club of Yala since its inception. By removing financial barriers, offering comprehensive assistance, and fostering awareness, this initiative enables a brighter future for patients, enhancing their quality of life and

promoting equitable healthcare opportunities for all. Nepal Cancer Hospital & Research Center, Nepal Cancer Relief Society Lalitpur Branch, Upacharka Laagi Sahayogi Haatihar, and Open Eyes Nepal have collaborated with the Rotary Club of Yala to provide this support. Below is a list of activities taking place this Rotary Year:

| Sno | Location | Month | Beneficiary | Remarks |
|-----|--|----------|-------------|---------------------------------------|
| 1 | Satprayas, Teku | May | 101 | PAP Smear and Breast Cancer Screening |
| 2 | Patan Industrial Area) | February | 100 | |
| 3 | Kanchanrup, Saptari | January | 435 | |
| 4 | Surunga, Saptari | December | 263 | |
| 5 | Pawan Prakriti School, Imadol | October | 80 | |
| 6 | Kanibahal Ward #6 | July | 124 | PAP Smear Test |
| 7 | Satdobato Youth Club | July | 80 | |
| 8 | Everest Fashion Fair Craft | December | 120 | Awareness |
| 9 | Nepal Cancer Hospital No Tobacco Day Debate Competition | May | 80 | Debate Competition |
| 10 | Cancer Patient Treatment Support to Sujeeta Nakarmi, Chowdhary, Riyansh Buddha, Karuna Khadka, Saluna Shrestha, Sushma Maharjan, Gopal Baidhyakar, Bina Maharjan, Sudhir Lama, Alim Kiwali, Sushila Shrestha, Mandira Bhujel, Sapana Rana Magar, Saraswoti Karki | | 12 | Cancer Patient Treatment Support |
| 11 | Stand-up for Breast Cancer Program Kabita Kumari, Anjana Bishwokarma, Putali Maharjan | Jul-May | 3 | Breast Cancer Support |
| 12 | Digital Video Colposcopy Machine Handover to Nepal Cancer Relief Society | August | | |
| 13 | District Police Range, Lalitpur | July | 50 | Cancer Awareness Program |
| 14 | 39th Cancer Survivor Meet | February | 12 | Survivorship on a Canvas |
| 15 | Prasuti Griha, Manmohan Memorial Institute of Health Science, Kathmandu Model Hospital School of Nursing, Patan Hospital and Kanti Hospital | May-June | 350 | Retinoblastoma Awareness Program |
| 16 | Saughat Chadara, Sushil Ale Magar, Saransh Thapa | May-June | 3 | Eye Cancer Treatment |



Use **Mobile Banking** and make your busy lives easier !

- Check balance
- Transfer funds
- Pay Bills
- Book flights
- Statements
- Top-up
- QR Payments
- ... and many more

Download the **Prime Smart App** today!



Support Number
01-4232260
info@pcbl.com.np



STAY SAFE STAY CONNECTED



MENAK JEWELRY

Pulchowk 3, Narayani Complex
+9779851012613
sailendrabajracharya@hotmail.com

Lounge
KEY

CHANGE THE WAY You Travel

Waiting Made Luxurious

**AIRPORT
LOUNGE FACILITY**

Kumari Visa Card Holders



AVAIL AT 1100+
AIRPORT LOUNGES
ACROSS THE GLOBE.

कुमारी बैंक लिमिटेड
KUMARI BANK LIMITED
सबैका लागि, सधैँका लागि

कुमारी बैंक लि. डिजिटल बैंकिङ्ग प्रणालीको प्रवर्द्धन गर्दछ।

For any queries and support, Please call us at 01-5970499



Kartik Nach Mask Maintenance by Rotary Club:

On September 2nd 2022, Treasurer Rtn Om Krishna Shrestha handed over Rupees 30,000 to Mr Kiran Chitrakar of Kartik Nach Preservation Committee for Maintenance of Mask of Dancers.





CREATE HOPE
in the WORLD

Fruit Tree Seedling Plantation

Each year, Rotary Club of Yala works with a variety of community to provide and plant trees. This year, we have decided to plant Fruit Tree into the community based schools in Lalitpur, Nepal. School Tree Planting projects help connect students to the benefits of trees and foster environmental stewardship. This school tree seedling planting program is a learning opportunity to get kids involved in the environment and conservation of our natural resources.

We have chosen varieties of Avocado and Lemon and planted them with the help of students and few teachers. In the month of July and August we have had planted 60 Fruit Trees in Bal Binod Secondary School, Tika Vidyasaram, and Clark Himalaya School and Basuki School Lamatar.



Free Health Camp

More than 100 people benefitted from a free health camp organized by Rotary Club of Yala.

| SNo | Description | Month | Partner With | Beneficiaries |
|-----|---|----------|---|---------------|
| 1 | General Health Camp during Krishnajanmashthami @Patan Durbar | August | Anns Group of Yala & Nepal Cancer Hospital | 100 |
| 2 | General, Gyano, Dental, Blood Donation Camp in Kotdanda, Godawari | October | Bishankhu Narayan Health Post, Kot Danda Health Post, Nepal Red Cross Society, and SOWA Healthcare Center | 102 |
| 3 | Maha Shivaratri Free Health Camp | February | Nepal Cancer Hospital | 500+ |



Library in Shree Bhanodaya Basic School

In an effort to establish a library at Shree Bhanodaya Basic School, a government school located in Sana Gaon, several individuals and organizations came forward with generous contributions. Paiva Tara Pradhan, the granddaughter of former President Rtn Urmila Shrestha, donated books worth Rs 54,000. Additionally, Laxmi Bank provided books worth Rs 50,000, and Rtn Gautam Shrestha, the President for the year 2022-23, collected Rs 50,000 from friends on social media, which was used to purchase books.

Apart from the book donations, Paiva Tara Pradhan also contributed Rs 18,000 towards a coloring bookshelf. With these combined efforts, over 700 books were donated, totaling Rs 1.5 lakh in value. Later on, Rtn Urmila Shrestha further supported the library project by contributing Nrs 29,900 and an additional Rs 50,000.



Blood Donation

| Sno | Location | Month | | Partner With |
|-----|--------------------------------|----------|----|--|
| 1 | Patan Durbar Square | April | 64 | CI Kathmandu Lady, Lions Club of Kathmandu Social Circle, Lions Club of Kathmandu Blood Circle, Radio Audio and Green Valley Green Nepal |
| 2 | Patan Durbar Square | February | 24 | Rotaract Club of Yala |
| 3 | Kot Danda Health Post Godawari | October | 22 | SOWA Healthcare Center, Bishankhu Narayan Health Post, Kot Danda Health Post, and Nepal Red Cross Society |
| 4 | Kanibahal Ward #6 | July | 26 | Nepal Cancer Hospital |



Oxygen Concentrator to Mental Hospital, Patan

The Patan Mental Hospital received an oxygen concentrator from the Rotary Club of Yala, with the president of the club, Rtn Gautam Shrestha, leading the handover. Senior officials and doctors from the hospital were present to accept the equipment, alongside representatives from both the hospital and the Rotary Club of Yala. The generous contribution of the oxygen concentrator was made possible by Ms. Lalita Kumari Pradhan.



Walkathon for diabetes awareness:

Aarus Life Style Hospital, in association with DEAN Nepal, Pragya Foundation, and Rotary Club of Yala, organised a walkathon to create awareness on diabetes and its prevention and healthy lifestyle in Patan Durbar Square on 12th November 2022 Saturday. The walkathon, which started at Patan Durbar Square, passed through Mangal Bazaar, Pulchowk, Kupondol and Maitighar Mandala. Honorable Deputy Mayor of KMC, Sunita Dangol was also participated in that event. More than 100 people participated in it. The program was coordinated by Rtn Dr Santosh Shakya.



Community School Toilet Project

Rotary Club of Yala built toilet under “WASH in Schools” project is to improve the health of the school children of Phulchowki Secondary School, Thaiba, Godawari Municipality. Major components of this project is: (i) Better and user friendly sanitation and hygiene facilities such as construction of toilets, hand washing, and solid waste management; (ii) Build well (iii) Access to safe drinking water. The project was funded by Rotary Club of Yala, Phulchowki Secondary School, Rotary Club of Jindalee and RID 3292.

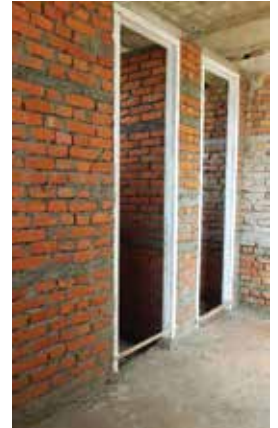

Water Tank to Snehi Kaakha

The Rotary Club of Yala in associated with Rotaract Club of Yala has once again demonstrated its commitment to making a difference in communities by donating a large water tank to a Nepal Snehi Kaakha, Lalitpur. The tank, with a capacity of 2,000 liters, was handed over by President of Rotary Club of Yala Rtn Gautam Shrestha and President of Rotaract Club of Yala Rtr Situ Tamrakar. With this donation, the organization will be able to store water more effectively and provide more reliable access to clean water for the association.





Wheelchairs Distribution

The Rotary Club of Yala handed over 10 wheelchairs to:

- Conflict Victim Disabled Society Nepal, Sankhu Kathmandu District = 4 Wheelchairs
- Shyampati Health Post, Namobuddha, Kavre District = 1 Wheelchair
- Daapcha Health Post, Kavre District = 1 Wheelchair
- Medical Rehabilitation Organization = 2 Wheelchairs
- Nepal Disabled Women Association = 1 Wheelchair
- Mother Nepal Child Home, Tarkeswor = 1 Wheelchair

Financial Support to Kidney Patient's Treatment

The Rotary Club of Yala on Thursday donated Rs 50,000 for the treatment of 49-year-old Pooja Dewan Napit, who was admitted to Bir Hospital for kidney failure.

President of Rotary Club of Yala, Rtn Gautam Shrestha handed over a cheque of Rs 50,000 to Pooja's son Siraj Napit. Pooja's husband Shiva Napit said her 24-year-old son Siraj will donate his kidney.



Mataya Foot Massage, Health Camp, Water and Juice Distribution

Mataya is one of the most important festivals in the Newar community in Lalitpur. Celebrated normally in the month of August in the Gregorian Calendar. It is celebrated the day after the festival of Gai Jatra. During Mataya individuals walk to almost all the temples, stupas, chaitye in and around the old city of Lalitpur. Thousands of individuals carrying candles and torches, traditional musicians playing instruments, and men and women who dress in comical attire. During the day of Mataya individuals gather at the lead locality from where Mataya is to begin and start their journey. They walk the entire route in one day, and some choose to make the journey bare foot.



Rotaract club of Yala in associated with Rotary Club of Yala organized health camp and free foot massage at Saugal, Lalitpur. Provided medical support and foot massage to 100+ devotees in 2 different places Tangal and Nagbahal, Lalitpur. Rtn Sushil Bajracharya contributed Rupees 5,000, Rtn Anju Shrestha contributed Rupees 5,000 and 30 pieces of Real Juice, President Rtn Gautam Shrestha provided medical accessories like gloves, bandage, etc, Rtn Kanti Shrestha provided 365 Pieces of Real Juice, Rtn Rasu Shrestha from RC Gyaneshwor provided 500 masks, Ann Badri Laxmi Joshi contributed Rupees 1,000 and other services was provided by Rotaractor.

Hearty

Congratulations !!!

Rotary Club of Yala

*on the occasion of its
27th Anniversary*

मुक्तिनाथ विकास बैंक
MUKTINATH BIKAS BANK
"जनता बैकमा होइन, बैंक जनतामा जानु पर्दछ"

बचत शब्द छोटो
अर्थ मिठो

Member of
EUROPEAN
MICROFINANCE
ASSOCIATION

Member of
Global Alliance for
Banking on Values

Toll Free Number :16600149999

Retinoblastoma Awareness Program

In an impactful collaboration with Open Eyes Nepal, the Rotary Club of Yala spearheaded a highly successful awareness program on Retinoblastoma. This program was conducted at various institutions including Prasuti Griha, Manmohan Memorial Institute of Health Science, Kathmandu Model Hospital School of Nursing, Kanti Hospital, and Kathmandu Medical College. The primary objective of the program was to disseminate knowledge about this rare type of eye cancer that primarily affects children. Renowned doctors from the prestigious Tilganga Institute of Ophthalmology delivered informative sessions, emphasizing the significance of early detection and timely treatment for retinoblastoma.

Dedicated doctors such as Dr. Purnima Rajkarnikar Sthapit, Dr. Malita Amatya, and Dr. Anushree



Adhikary shed light on the critical importance of identifying retinoblastoma in its early stages and initiating immediate treatment. Additionally, Umang Sharma and Rabin Shrestha provided a concise overview of Open Eyes Nepal. Notably, Rtn Gautam Shrestha, the President of the Rotary Club of Yala, and PP Rtn Sushil Bajracharya underscored the significant role played by Rotary organizations worldwide. The program witnessed a remarkable turnout of over 350 participants, further enhancing its impact and reach.





CREATE HOPE
in the WORLD

RC Yala Hosts Successful Blood Donation Program during Birthday of Madan Krishna Shrestha

In a selfless effort to contribute to the community and make a positive impact, On the occasion of legendary artist Mr Madan Krishna Shrestha's 74th Birthday, Rotary Club of Yala organized a blood donation program in associated with Nepal Cancer Relief Society, Lalitpur Branch, and Lalitpur Ward #16, Held at the Patan Durbar Square on April 23rd, the event saw an overwhelming response from donors & participants who generously gave their blood to help those in need.

The program was organized in collaboration with JCI Kathmandu Lady, Lions Club of Kathmandu Social Circle, Lions Club of Kathmandu Blood Circle, Radio Audio and Green Valley Green Nepal. Donors underwent thorough screening to determine their eligibility, and all necessary precautions were taken to maintain a clean and sanitized environment.

After blood donation program, 74th Birthday of Veteran Artist Madan Krishna Shrestha's Birthday was celebrated by entertainment program, cake cutting, sagun and samaye baji program at Keshav Narayan Chowk, Patan Museum.



ROTARY C



"Safety is our priority"



MANANG AIR

+977 9801180462/463/464/465

WWW.MANANGAIR.COM.NP

106 N K Singh marg, Araniko building, Minbhawan, Kathmandu, Nepal +977 1- 4115984/85/

Hearty Congratulations!!!

Rotary Club of Yala

on the occasion of its 27th Anniversary



Maheswor Shrestha
CEO



Everest Fashion

Khumaltar Height-15, Lalitpur, Nepal

Tel: 977-1-5525187, 5541013, Fax: 977-1-5525906

URL: www.everestfashion.com



First Fair Trade-USA Certified Company in Nepal
World Fair Trade Organization Guaranteed Member



With Best Wishes

From the makers of



Empaz

Empagliflozin 5/10/25 mg
Scored Tablets

Telsartan/H/AM

Telmisartan 20/40/80 mg Tablets/
Telmisartan 40 mg + Hydrochlorothiazide 12.5 mg Tablets/
Telmisartan 40 mg + Amlodipine 5 mg Tablet

Rovastin

Rosuvastatin 5/10/20/40 mg Tablets

Lintor M Forte SR 1000

Linagliptin 5 mg + Metformin Hydrochloride
Sustained Release 1000 mg Tablet

IFOL XT

Ferrous Ascorbate 100 mg +
Folic acid 1.5 mg Capsule

Seropram

Escitalopram 5/10/20 mg Tablets

Luzo

Luliconazole 1% w/w Cream

GET IN TOUCH WITH US

Corporate Office:
Adarshnagar, Birgunj, Nepal
Tel.: +977-051-591235, 591277
Email: quest.brj@quest.com.np

Marketing Office:
Dean Sadan, Teku, Katimandu, Nepal
Tel.: +977-01-5339296, 5340304
Email: quest.ktm@quest.com.np

Factory:
Chhatapipara, Bara, Nepal
Tel.: +977-051-580172, 580186
Email: quest.factory@quest.com.np



Celebrating 20 YEARS OF EXCELLENCE

Innovating for Healthier Future



Sustaining Education

Empowering Community and Government Schools through an Array of Transformative Initiatives Including the Provision of Premium School Furniture, Life-Changing Scholarships, Nourishing Mid-day Meals, Essential Stationery Supplies, Shoes & Tracksuits, and Comprehensive Dental Check-up Program.



| Sno | Description | Month | Location | Beneficiaries | Amount |
|-----|--|----------|---|---------------|----------|
| 1 | Established Library | July | Bhanodaya Basic School | 415 | 1,72,000 |
| 2 | Distribution of Stationery Items & Food and Fruit Tree Seedling Plantation | July | Clark Himalaya Memorial School | 59 | 10,500 |
| 3 | Scholarship engineering student and little kid | July | Keshika Sawaden & Sakcham Basnet | 2 | 1,07,000 |
| 4 | Channel Gate & Stationary | August | Basuki School, Lakuri Bhanjyang | 100 | 17,550 |
| 5 | Copies Distribution to SINCHAHITY MAHILA SCHOOL | December | Sinchahity Mahila School | 20 | 30,000 |
| 6 | Provided 30 Desk & Bench | December | Nepal Rastriya Secondary School Bardiya | 90 | 2,24,740 |
| 7 | Carpet, Stationary and Tiffin | December | Bramahini School, Thecho | 45 | 47,360 |
| 8 | Free Dental Check-up Camp | December | Jagruti Academy | 547 | 50,000 |
| 9 | Braille Papers, Books, Tiffin & Financial Support for differently-abled Children | January | Disabled Service Association | 35 | 41,120 |
| 10 | Tracksuits for the Students | January | Shree Janak Primary School, Chitlang | 60 | 60,000 |
| 11 | Mid-day meal for 2months | February | Clark Himalaya Memorial School | 65 | 55,000 |
| 12 | School Shoes | March | Needy children of Naya Nepal Bal Ashram | 20 | 20,000 |
| 13 | Scholarship Program Launched to Support Community Students | April | Clark Himalaya Memorial School | 8 | 84,000 |
| 14 | Supporting Books for Library | April | Bhanodaya Basic School | 415 | 29,900 |
| 15 | Free Dental Check-up Camp & Tooth Paste and Brush Distribution | May | Shree Navajyoti Secondary School in Jhaurashi, Lalitpur | 200 | 18,000 |
| 16 | Empower educational support/scholarships for the identified children / siblings of the selected 200 women, as well as provide livelihood equipment and support for 200 girls | May | Musahar Basti of Dhanusa District | 200 | 5,00,000 |



CREATE HOPE
in the WORLD

ROTARY CLUB OF YALA | 27th Anniversary Souvenir 2023-24

| Sno | Description | Month | Location | Beneficiaries | Amount |
|-----|---|-------|-------------------------------------|---------------|------------------|
| 17 | Inter School Speech Competition on No Tobacco Day | May | 20 Students of 10 Community Schools | 20 | 10,000 |
| 18 | Funiturer,etc | June | Clark Himalaya Memorial School | 65 | 5,50,000 |
| | | | | 2,301 | 20,27,170 |

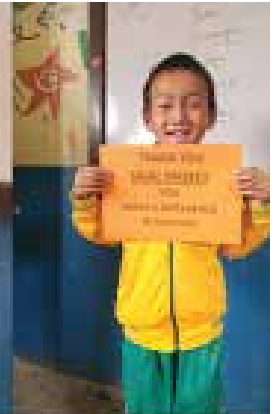

Rotary Club of Yala Anns Group Activities Report 2022/23

1. On 2nd July, 2022, Anns group participated in tika and sagun distributing function to dignitaries, guests and rotary members on installation day.
2. On 15th July 2022, Anns group along with Rotary Club of Yala organized a program of distribution of Copies, Pencils, and Fruit Juice worth of Rs 10,500 for 65 students of Clark Himalayan Memorial School (Locally popular as Japanese School) and tree plantation program. Anns president Purna Laxmi Shrestha disseminated information of the continuing Rotary support to this school and commitment to support further and later Dr Rabintra Roy explained students about the tree plantation methods and ways of taking care of the plants in order to bear the fruit at the near future,
3. On 26th July 2022 at the invitation of Rotaracts club of Yala Anns President Purna Laxmi Shrestha and General Secretary Rtn Manjari Tamrakar participated the Mehendi program at Patan,
4. On 30th July, 2022 participated the event of Pap smear and blood donation at Kanibahal organized jointly with Rotary Club of Yala and ward office,
5. On 9th August 2022 Anns Group jointly with Rotary Club of Yala handed over Rs. 10,000 for Channel Gate and Rs 7,550 for Copies, Pencils and Juice to Basuki School, Lakuri Bhanjyang,
6. On 13th August participated in "Mataya" festival where Anns General Secretary Rtn Manjari Tamrakar contributed Rs 1000 on the occasion in order to facilitate the "Tuti sikegu" program,
7. On 19th August 2022, On the eve of Krishnastami a free health camp was organized at Mangalbazaar to devotees by Nepal Cancer Hospital and Research Centre, Harisiddi supported by Rotary Club of Yala Anns Group and where 100+ people benefitted from the service ,
8. From 30th Aug to 7th September participated the Swimming training program at Nobel swimming pool at Imadol in association with Rotaract club of Yala,
9. On 10th September 1st Anns meeting was conducted at residency of Anns President Purna Laxmi Shrestha at Mount view residency phase no 2, @108, Harisiddi,
10. 14th September- Participated in Cleaning program of Banglamukhi temple along with RC Yala, Rotaracts, and Interacts,
11. 14th October- As per the request of Conflict Victims and Disabled Society, Sankhu, Food distribution program at the cost of Rs10,990 was done and jointly with Rotary Club of Yala 1 (one) Wheel chair was presented to the disabled member of the society,
12. 9th November- Additional 3 wheel chair were distributed to Conflict victims and Disabled Society Sankhu in association with Rotary Club of Yala,
13. 12th November morning - Participated in walkathon program organized by diabetics Centre and Dr Santosh Shakya ,
14. 12th November- 2nd Anns meeting was organized at site of picnic venue at Switzerland park,
15. 17th November- On the auspicious event of 13th anniversary of Jyestha Nagarik Diwa Sewa Kendra, Sunakothi, 30 thousand of cash was handed by Rtn Padam Krishna (25000) and Anns Minu Shrestha (5000) to the concerned official of the organization,





CREATE HOPE
in the WORLD



16. 30th November, sweater, cap and socks of the total cost of Rs 23,550 were presented to 30 old aged citizens, member of phutung navajeevan Kendra which partially were donated by PP rtn Dr Sumitra Manandhar(6150), Rtn Sangita Amatya(2000), and Rtn Sworupa Shrestha(1000)
17. 15th December – Stationery distribution program was held in association with RC Yala, at Sinchahiti Mahila School.
18. 15th December - Cancer awareness program was organized at factory of Everest Fashion, Taukhel in association of Cancer Hospital and Research Center, Harisiddi where 125 ladies attended the class.
19. 18th December- 18.1 Carpet at the cost of Rs 22560 was presented by PP Pramod Pradhan/ Anns Usha Pradhan for students and teacher of class one so that to be used to sit during their study time, so as 18.2. Surendra G Shrestha/ Nirmala Shrestha distributed Rs 7600 for one months tiffin, other one month from Anns fund of Rs 7600, 18.4 Stationery for one year for cost of Rs 7100 by Rtn Basanta/Anns Minu and additional amount were added by others participants as well. Total contribution of 47360 was handed to principal of brahmayeni school, Sunakothi,
20. 24th December - 3rd Aans meeting was held at Anns General Secretary Rtn Manjari Tamrakar's residence at Mount view residency phase 2, Harisiddi,
21. 25th December- Under humanity Program, Visited Divya Sewa Kendra, Mandikhatar, to distribute food and clothe of cost Rs 10,500 sponsored by Anns Ramuna/Rtn Prem singh
22. 6th January - Under humanity program Anns Mita Shrestha/Rtn Dr Dinesh shrestha distributed sweaters to 500 students of Neelbarahi School,
23. 13th January- In association with Rotary Club of Yala visited Disabled service association Bungamati for the distribution of Braille paper, books and tiffin,
24. 14th January - Fourth Ann's meeting was held at PP Rtn Dr Sumitra Manandhar's residence, Chitlang,
25. 10th February – Participated in the program of Cash donation of Rs 5000 to Clark himalaya bungamati for mid day meal,
26. 17th February - Handover of cash of Rs 25,000 to blood cancer affected 2 year child Riyansh at Le Bagaicha in association with RC yala,
27. 18th February 18 – Participated in the walkathon heritage walk program from Mangalbazaar to Kirtipur,
28. 24th February - 5th Aans meeting was held at Le Bagaicha, Jawalakhel,
29. 25th February – 6th Ann's meeting was held at residence of Rotarian Jitendra Nakarmi and Anns Treasurer Gyanu Nakarmi, Dhapakhel,
30. 8th March – Organized the shoes distribution program at Naya Nepal samaj Kendra (Bal ashram) shantinagar in association with Rotary





- Club of Yala, where 25 pairs of shoes were distributed,
31. 11th March – 7th Aans meeting was held at Evoke restaurant,
 32. 15th March – Participated Kathmandu Photo exhibition at patan and conducted 8th Aans meeting at PP RtnDeepak kr Shrestha/PE Rtn Shobha Devi Shrestha’s residence,
 33. 22th March – Organized Food distribution program at Satprayash old age home, Pachali Bhairav where Rs 9575 worth of goods and cash were distributed,
 34. 5th April - Food and clothes distribution program was held at Naya Nepal samaj Kendra (Baal ashram),
 35. 7th April - 9th Aans meeting was held at the residence of Anns Badri joshi and Rotarian Er Surendra Gopal’s residence,
 36. 15th May – Cash donation of Rs 5000 was done for Food distribution program at Shanti Ashram, Shankhamol,
 37. 20th May - Service of Free PAP Smear and Breast Cancer Screening Tests were Offered on the premises of the NGO Satprayas in association of Rotary Club of Yala and Nepal Cancer Hospital & Research Center. 101 persons benefitted from the camp,
 38. 28th May - Cash of Rs 5500 was provided to two cancer patients of National hospital & Cancer research Centre for food provisions,
 39. 5th June - Food offering program to 45 persons



- of old age persons at Jestha nagarik diwa sewa Kendra, Badegaon,Lalitpur was held,
40. 12th June – 11th Aans meeting was held at Boudha Jana Bihaar, Sunakothe. At the same venue In association with RC yala participated the program where Rotarian Jeetendra and Aans Gyanu presented a 500 watt Speaker and khaja to 71 senior citizens members of Sunakothe Bihaar,
 41. Anns family members Ersa Joshi and Annie Pradhan. Rs. 15000 each (total Rs 30000) continued scholarship to 2 students of Bhanodaya school,
 42. On 2079/4/4 Shrena Joshi, daughter of Anns Badri laxmi Joshi provided Rs 15000 scholarship to student of Shree Satya sai Kendra thapathali,
 43. Anns handover program on 23rd June 2023.





CREATE HOPE
in the WORLD

नेपा तजिलजियात हिउपा हय्मा:गु



रो. धुबमान प्रधान

नेवा तजिल हलिमय् छगु च्वयला:गु धका भी नेवा तय्सा मधासाँ पिने देयापिं तहोपिं थीथी मनुतसे धाय्गु या:गु दु । उकि मध्ये छम्ह नाँकाय् बह:म्ह स्वीजर लायण्डया टोनिहायगनाँ ख: । वय्कया सफुति न्हयो व्वयात:गु दु कि थन उबलय् हे निग:(शहरया) थपुज्वी धुंकुगु दु गुबले यूरोप देशं जूयाच्वंगु इलय, लिसें थनया गुथिया बिकास यानाँ थीथी थाय् देग: चपा, बुँया ध:, तुं, ल्वंहिति या म्हालासाला याय्गु लिसें ने वा तजिलजियात न्हयाकेगु जूया च्वंगु ख: । तर लिपा वया लिपाया देन्हयाकामि पिन्सं नेवा:तय्गु च्वन्ह्यागु तजिलजियात सहयाय् मफया गुथियात: स्ये केंगु कुत: जुल, अले तजिलजि स्यस्यं वनं, म्होहे जक जात्रा पात्रा न्हयाके माल सा थी थी थाय् सतह दे ग:या म्हालासा नं याय् मफया वनं । थन न्हेथने मा:गु छगु थथे दु, छम्ह: गैह नेवा खसमूलया अमेरिकाय्

च्वना च्वंम्ह छम्हेसिन बुँद्यो रथ साला न्हयाका च्वंगु देया तहोगु धन नास जुया च्वन धका फेसबुकय् त:गु ख: , तर थुक्रिया सुनानं नेवा वा नेपाया सुनानं छुं हे लिस: बिउगु मरु तर छम्ह अमेरिकाया हे छम्ह अने याहे अमेरिकनं व मनुयात: नथीक्क लिस: बिया दिल कि जनतां थ:गु धेबा द्य:या नामे छानांत:गु बुँ फुक्क सरकारं दुकासिनि सरकारं मयासें गाइला, अप्पायहो गु च्वन्ह्यागु तजिलजियात मजिउ धाइपिला तजिलजि छुहेमरुपि पशु थज्यापिन्त जक थज्यागु खँ ल्हवनी धया बिल । थुक्रिया लिस: लिपते मवल । नेवा: तजिलजि स्वय्गु ख:सा स्वनिग:या लिसें नेवा बस्ती बस्ती नापं अथेहे थपु जुया च्वंगु ख:, नेवा बस्ती बाहेक न्हापा मेगु बस्ती अथे थपु जुगु खने मरु ।



भी नेवात: तसकं धर्मनं दूपिं ख:, न्ह्यागु नख:चख: भव्य् ज्वी बले, थ:जक नयां मगानां पिने च्वं पिन्तनं इनां बीगु तजिलजि दु , गथेकि य:मरी इनेगु, समय् बजि इनेगु, साख:ल: इनेगु याइगु चलन दु, थव तसकं भी नेवा:तय्गु च्वन्ह्यागु तजिलजि ख: । अथे ख:यानं आया इले छँ भव्य् गुथी ज्वीबलय् भव्य् भागु छगु ल्वखाय् न्हयोने तय्गु तजिलजि आतकं दनि, न्हापा जूगु थव भव्य्भाग यंका नैपिं यक्कु हे दु, थव उगु जमानाय् तसकं च्वन्ह्यागु तजिलजि ख: । तर आया इले अथे भव्य भागु ल्वखाय् न्हयोने तया का:वैपिं सुंहे मदय् धुंकल । सुनांनं का मदुसां भव्य् भागु तय्गु तजिलजि धासा: आतकनं न्हयाका च्वंगु दनि, व: भव्य्भाग ला लँय् वइपिं लँजवा पिन्स न्हया व मोटर साइकल गया वैपिन्सं छ्याल बिछ्याल याना लया छगुली फोहर जुया भीगु तजिलजियात नसा: सितिक्क छोगु ताय् का मेपिं मनुतय्सं आ बांमलागु मिखां स्वया च्वंगु दु । उकि थज्यागु तजिलजियात त्वता: बरु धेबाहे सुं चिमि पिन्त: नय्मख:ना च्वंपिन्त थासेहे वनां इनांबिगु यासा बां लाई । इब्यो स्वया तजिलजि हिउपा हय्मागु ताय् का ।

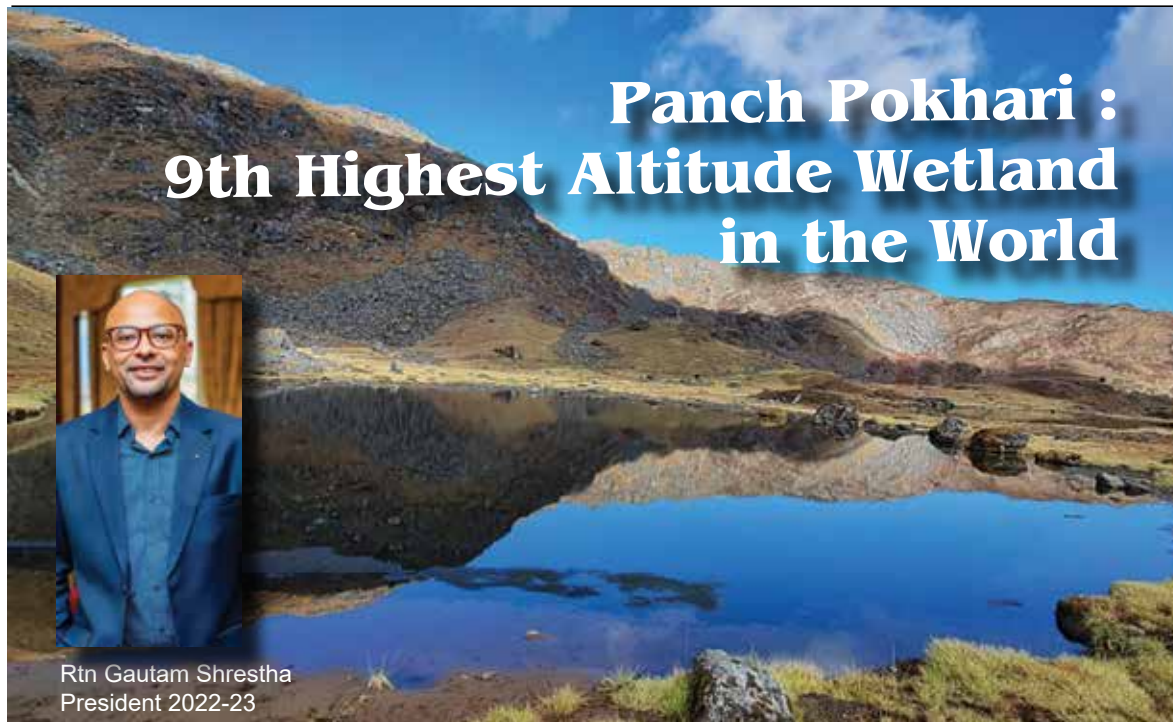

Panch Pokhari : 9th Highest Altitude Wetland in the World



Rtn Gautam Shrestha
President 2022-23

Nights, we slept in so called tea house somewhere in NOSHYAMPATI (3700m) as the wind whistled outside. The room was furnished with wooden bunk platforms for some 20 people. We are lucky that night that we found an unoccupied bunk. Food was so horrible even our hungry stomach say no to this. The toilets were literally over flowing with dirt. People prefer often open ground, wherever the urge struck. Only one tea house was opened during November and we didn't had any choices in that coldest temperature. Can't sleep whole night due to weather and lack of additional blankets. At 5:00 AM, we left our bed for sunrise, though lots of trekkers meditated inside there blankets. Every time is tea time in Nepal. Started our first day trek from village called DEURALI (an hour drive from BHOTANG) after having black tea. BHOTANG is the social and commercial hub before PANCH POKHARI. We all trekked at our own pace, pausing often for refreshment at trailside teahouses and to chat with passersby. Most of the time I have been trekking with a group of complete strangers. No less but sometimes I had also been undertaken with one or two trusted friends, or alone. In trekking have confidence in your teammates is no small concern. One trekker's actions can affect the welfare of the entire team.

Delicious foods was waiting for us at TUPI DANDA. Here we had rice, lentil, and

mushroom potatoes mix vegetables and pickle. Clicked pictures, selfie and uploaded to social media platforms. After our lunch we resumed the trek toward NOSHYAMPATI. The trail took us past glades of Junifer and dwarf birch, pine trees, thundering waterfalls and lakes.

“Only 10 minutes more” was readymade reply whenever and wherever you asked “How far is the next destination?” After so many 10 minutes we reached NOSHYAMPATI. This was the place where we rested that day.

Next day we continued our trek towards PANCH POKHARI (4100m) from NOSHYAMPATI. From NOSHYAMPATI, paths were filled with rocks, and many stairs before LAURI BINA (without a stick). There are myths that one should leave their stick in LAURI BINA. But nobody cared to do so. The last rocky dangerous stairs lead us towards the beautiful PANCH





CREATE HOPE
in the WORLD

POKHARI (5 holy Ponds). PANCH POKHARI is not only naturally beautiful but also the ninth highest altitude wetland in the World. PANCH POKHARI is named as because there are a total of 5 divine ponds in the SINDHUPALCHOWK district of Nepal. PANCH POKHARI is popular destination during Janai Purnima (one of the festivals of Nepal) in the month of August among Hindu and Buddhist pilgrims.

Exploring few hours in this comparatively less explored region of trekking despite the spectacular scenic wonders. There is also a saying that, taking a bath in these scared ponds, it will wash away bad karma and remove impurities from our past. Whether it was real or myth, but few of us undress and jumped into the pond and worship the god of the god "Mahadev". Jay Sambho. After having lunch we headed back to NOSHYAMPATI. Evenings were peaceful. Less people than yesterday. Not to mention dinner here but we slept good 8 hours. Few of our teammates was outside the tea house. Counting stars.

Woke up earlier in the morning to see the sunrise. One boy got us black tea. Having 3-4 cups of black tea with biscuits, we trek down hills towards BHOTANG, where we parked our jeep.



Last but not least "The fastest way to make a friend for life is to travel with a STRANGER." Travel experiences based on November 2020 Panch Pokhari Trekking



www.igiprudential.com

**निजीवन बीमा सँग सम्बन्धित
हरेक प्रकारको जोखिम वहन गर्ने
जिम्मेवारीका साथ अगाडी बढ्दै**



**IGI PRUDENTIAL
INSURANCE LIMITED**

IGI PRUDENTIAL INSURANCE LIMITED

Corporate Office : Narayanchaur, Naxal, Kathmandu, Nepal

Toll Free

16600 170252



Le Bagaicha Grill & Bar Pvt. Ltd.

Nawalakhel, Lalitpur
 Phone: 01-5548148, Cell no 9851148092 / 9849620592
 Email: lebagaichagb@gmail.com
 newsbagaicha@yahoo.com

गुडविल फाइनेन्स लिमिटेड (वित्तीय संस्था) GOODWILL FINANCE LIMITED

राष्ट्र बैंकबाट 'ग' वर्गको इजाजतप्राप्त राष्ट्रियस्तरको संस्था

Corporate Office
 Narayanasar, Kathmandu, P. O. Box: 8867
 Phone: 5544039, Fax: 4543414
 Email: info@goodwill.net.np

Branches

| | | | | | | | | |
|-------------------|------------|------------|------------|--------------|------------|------------------|------------|------------|
| Nayabazar | Indrachowk | Bhaktapur | Kumaripati | Tripureshwor | Nayabazar | Itahari, Sunsari | Birtamod | Nepalgunj |
| 590 | 5329554 | 6620067 | 5408690 | 5331533 | 5910738 | 025-587051 | 023-530548 | 081-532056 |
| Chandragiri, Dang | Ilam | Phidim | Butwal | Bardibas | Dhangadi | Nawalpur | Gaindakot | Bhairahawa |
| 063350 | 027-520949 | 024-521068 | 071-537282 | 044-550102 | 091-417357 | 046-570060 | 078-501411 | 071-590963 |

Everyone's Cup Of Tea

- EASY LOAN PROCESSING
- DEPOSITS WITH HIGH RETURNS

ROTARY CLUB OF YALA

Rotary International District 3292 Nepal Bhutan

Strategic Plan for 2022/23 - 2024/2025

The strategic plan of RC Yala for 2022/23 – 2024/25 was developed by a Club Assembly on 11TH June 2022. This three-year plan was reviewed at the Club Assembly held on 10TH June 2023 Saturday. Following the review, the Assembly assessed the progress made in last one year and proposed the annual plan for 2023/24 incorporating needful updates in the programs and activities. Altogether 42 participants attended the Club Assembly. AG Kumud Tripathy graced the plenary session and gave valuable inputs. The next exercise will develop detailed action plan specifying activities with timelines, budget and responsible team members for the Rota Year 2023/24. A second review will be in the month of June 2024 to assess progress in two years e.g., 2022/23 and 2023/24. The third and last review will be in the month of June 2025 to assess the three years' progress and develop strategic plan for 2025/26 – 2027/2028.

Strengths, Weaknesses, Opportunities and Challenges (SWOC) analysis:

1. Where are we now?

Club Strengths (internal)

- Adequate attendance in RWM
- Active participation of Anns, Rotaractors and Interactors in club activities,
- Excellent family values and relationship
- Many new and enthusiastic members are engaged in club activities
- Diverse fellowship events
- Diverse skills and experiences of members
- Extensive Rotary knowledge among growing members of the club
- Better Size of Members in the club
- 25% of Women members (a very good proportion compared to District average)
- Annual recognition program and specific awards established by RC Yala
- Quality Monthly Club Bulletin
- Good image within the district
- Club with PHS, PHF and MPHf etc.
- 100% Contribution Club
- Projects and activities related to community needs
- Community projects (cancer diagnosis and awareness, water and sanitation, support for elderly, special needs children and students, school support, girl child scholarship)
- Capable in responding to emergencies
- Good Fellowship
- Women Leadership

Today's date: 10 June 2023

Club Weaknesses (internal)

- Inadequate attendance in district events
- Only few members visit other clubs
- Knowledge about rules and procedures not up to the mark
- Sub-optimal use of expertise available in the club
- Defunct RCCs
- Inadequate number of international speakers in RWM
- Some club committees not adequately active and effective
- Inadequate mentoring of new members
- Humanitarian service of the club not promoted or reflected in media
- No members from print and electronic media houses
- Inadequacy in Public Relation and creating Public Image
- Contribution and participation in TRF not as desired (Members can afford but not motivated to contribute)
- Involvement of members in service projects not to the mark
- Link with potential international partners not up to the mark
- Not being able to translate relation with international partners into service projects
- Club with Major Donor
- Improper use of communication tools
- New member orientation



CREATE HOPE
in the WORLD

Club Opportunities (external)

- Strengthening working relationship with Anns Group and Rotaract Club and Interact Club
- Support from District Committees and officials
- Participation in District and RI events and host district event
- Creating RC Yala Endowment Fund
- Possibility to make best use of new members
- Possibility to enhance Rotary knowledge (members captivated in Rotary)
- Partnership with print and electronic media (local and National)
- Introduce media and other awards for culture and heritage exemplary humanitarian service works
- Interact with media houses
- Participation in municipal events
- Participation in social and cultural events
- Partnership with institutions RC Yala has already worked with
- Recognition of Club and Members for contributing to TRF
- Partnership with other Rotary Clubs for joint projects
- Access to Global and District grants
- To become a model club in the District (strong and united team, improved image, projects with high impact, effective partnerships, new leaders
- Environment project engagement

Club Challenges (forthcoming)

- Retaining club prestige and credibility
- Finding inspiring and exciting external speakers (international)
- Attracting members from media
- Raising funds for club projects
- Finding diversified International Partners for Global Grant Projects
- Increasing Club Attendance
- Networking with Corporate Houses

2. Where do we want to be (anticipated scenario if the strengths are utilized, weaknesses minimized, opportunities chased and challenges overcome) Target date: 30 June 2025

1. Good partnership and working relationship with international clubs; at least 5 sister clubs with effective joint program
2. Effective Regular Weekly meetings with attractive programs
3. At least 60% members actively participate in RWMs and club events regularly

4. Hosting three district events and co-hosting at least 9 district events annually
5. At least 25% members active in various important District roles
6. RC Yala Endowment Fund of at least Rs. 5 million established and operationalized
7. Initiation of the process to have its own club land and building
8. Membership growth of 20 (at least 50% women, 25% younger generation below 40)
9. 100% members registration at My Rotary every year and at least 50% using it at and 25% sharing in RWMs
10. Improved quality of membership (participation & contribution: Time, Talent & Treasure) in the club (indicators of quality members will be in place)
11. Improved skills amongst members and Anns to use digital systems (online meetings, apps, software, web)
12. At least 20 % members will take online courses in Learning Center
13. All new members to take online courses on Rotary Basics in the Learning Center
14. RC Yala recognized as a credible, vibrant and notable service organization.
15. Continuation of effective projects including their proper documentations
16. Enhanced image of Club and Rotary in the community and district level
17. Wider Distribution of Club Bulletin, Annual Souvenir, Rotary Magazine
18. Continuation of the RC Yala recognition and awards and establish at least one new award
19. Contribution of US \$20,000 to TRF and Annual Fund
20. 50% members are Paul Harris Fellow (PHF) and 30 % Multiple Paul Harris Fellow
21. At least 3 Paul Harris Society (PHS) members
22. At least 2 club members are major donors
23. Documentation of past projects
24. Two villages adopted and supported through new RCCs and/or revival of existing RCCs
25. Continued relation with past sponsored schools and communities.
26. At least 3 Global Grant projects implemented or under-implementation
27. Three schools adopted and supported to become child friendly (aligned with TEACH)
28. Continue projects on
 - a. support for senior citizens,
 - b. cancer prevention, treatment,
 - c. diabetes prevention and treatment
 - d. water and sanitation at households and schools
 - e. Educational support to girl students and children with special needs
 - f. extra-curricular activities (in schools)
 - g. Disease Prevention and Treatment

3. Vision statement:

RC Yala is recognized locally and in District 3292 as a strong and vibrant club with its members actively participating in high-impact service projects and club development with the support of Anns, Rotaract Club, Interact Club, partner Rotary Clubs, national and international and local authorities.

4. How do we get there?

To reach our vision, the following goals and actions are proposed for the year 2022/23. The proposed goals and actions fall within three strategic priorities of RI namely:

- a. Support and Strengthen Clubs;
- b. Focus and Increase Humanitarian Service, and
- c. Enhance Public Image and Awareness.

4.1 Club Administration Committee

Goals: (a) Make club meetings interesting and effective;
(b) establish good external relationship beyond club;
(c) Maintain good governance in the Club

Actions

1. Organize minimum 48 Regular Weekly Meetings
2. Explore ways to digitally connect members who cannot physically attend meetings for health reason and/or for being out of station
3. Organize Know-your-member (KYM) events at RWMs with fellowship program
4. Develop a club calendar for Rota Year 2023/24
5. Produce monthly quality Club Bulletins (news worthy for Rotarians and other clubs)
6. 12 Board Meetings, 6 Club Assemblies, 4 Admin Committee meetings, One Annual Meet
7. 12 guest speakers including 7 international speakers at RWM
8. 8 classification talks with priority to new members
9. Provide greetings and congratulatory cards to members and Anns
10. Maintain 60% attendance; recognize make-ups
11. Sister relationship with 2 International Rotary Clubs
12. 4 joint meetings with other clubs
13. Felicitation program for family members of Rotarians (SEE, +2, Bachelors, Masters) in collaboration with Anns Group
14. Installation Program, DG Visit, Women's day celebrations
15. Monthly happy hour / birthday celebration
16. 1 heritage tour
17. One Futsal or Table Tennis Tournament
18. At least two events tour/picnic/hiking outside Kathmandu valley
19. Publish Club Souvenir that captures club activities and Rotary Information
20. Review and amendment of club bylaws and bidhan (if required)
21. Ensure timely payment of club dues
22. Make up cards
23. Internal Rotary Quiz contest
24. Data achieving
25. Encourage members to participate in other club's meeting
26. Arrangement of telephone tree to make effective communication among members

4.2 Membership Committee

Goals: (a) Increase members to 55+ enticing unfilled classifications, women and youth;
(b) Retain minimum 95% of members,
(c) Enhance capacity, knowledge and skills of members
(d) Sponsor a new club

Actions

1. Conduct classification survey and update classification roster
2. Develop criteria for membership quality
3. Invite prospective members as guest speakers.
4. Induct at least 5 new members (media person, women, below 40s and potential future leaders beyond club)
5. Assign mentors for new members with mentor and mentees orientation
6. Engage new members in club committees and activities
7. Hold 4 Membership Committee meetings
8. Award for members on basis of Attendance
9. Minimum 15% members participate in various district events including district membership seminar
10. Happy hour once a month to motivate and for retention of member
11. Motivate Anns to be Rotary members
12. Conduct a membership feedback session using membership satisfaction survey and club health check forms (2 times)
13. Organize one Rotarian non-Rotarian interaction
14. Achieve over 95% membership retention
15. Organize continued education to update Rotary knowledge
16. Felicitation of children
17. One pre-induction orientation program for potential new members

Service Projects Committee

Goals: (a) Apply for at least 1 Global Grant projects and explore potential partners for the matching fund to the Grant Projects;
(b) Implement humanitarian service projects in collaboration with Anns, Rotaractors and Interactors
(c) Engage in climate change issues (adaptation and mitigation) and preserve cultural heritage (both tangible and intangible)

Global Grant Projects

- 1) Submit applications for Global Grants on water and sanitation facilities in public/community schools
- 2) Explore international and national partners for Global Grants on (a) Disease Prevention and (b) Environment Conservation

2. Disease prevention and treatment

- 1) Support needy patients (1)
- 2) Health Camps (3)
- 3) Annual Mataya Program with Rotaractors
- 4) Annual Blood Donation Program (3)
- 5) Health Awareness Campaigns (3)
- 6) Donate medical instruments/tools to the community health center (1)



CREATE HOPE
in the WORLD

7) MOU with different organization for health support of RC Yala, Rotractors, & Interactors

3. TEACH in adopted schools (3 schools)

- 1) Support to Community Schools (strengthening library, plantation of fruit tree seedlings for income generation and nutrition, WASH etc.) (3)
- 2) Scholarship to bright and needy students (10)
- 3) Provide school tiffin to needy students (30)
- 4) Enriching Library in Schools
- 5) Formation of interact club at schools
- 6) Prepare database of sponsored schools (log of RC Yala supports) in collaboration with Rotaractors, Interactors and school administration (1)
- 7) Distribution of dolls to community schools

4. Senior Citizens and Children with special needs

- 1) Support to senior citizens (day care and old age homes) in collaboration with Anns, Rotaractors and Interactors (3)
- 2) Support to 'children with disabilities' in collaboration with Anns, Rotaractors and Interactors (3)

5. Economic promotion

- 1) Organize vocational training to women group for income generation and for developing their entrepreneurship skills (1)

6. Climate Change and Cultural Heritage

- 1) Water, sanitation and hygiene (WASH) projects at schools and communities (2)
- 2) Financial Support for Culture (1)
- 3) Temple cleaning in collaboration with Anns, Rotractors, Interactors, LMC (3)
- 4) Stone tap cleaning in collaboration with LMC (1)
- 5) Cleaning of indigenous ponds in collaboration with LMC (1)
- 6) Fruit tree seedlings plantation in community schools (80 seedlings)
- 7) Silvicultural operation/enrichment plantation in previous plantation (engagement to the students from the respective school) (1)
- 8) Nepal Bhasa classes (how to speak Newari language with the original vocabulary) (6)
- 9) Talk series of Godavari-Phulchowki Conservation Area (2)
- 10) Awareness campaign on Godavari-Phulchowki Conservation Area (1)
- 11) Orientation on roof top kitchen garden
- 12) Demonstration plot of solid waste management at Godavari-Phulchowki Conservation Area
- 13) Construction and/or revival of conservation pond/s at Godavari-Phulchowki Conservation Area

The Rotary Foundation Committee

Goals: a) Enhance knowledge on TRF and Grants Management among RC Yala members and encourage them to actively contribute to the cause of Rotary Movement
b) Strive for contributing a total of US\$ 8375 in Cash to TRF

Actions

1. Participate in District Grants Management Seminar and other relevant events (3)
2. Ensure all TRF Committee Members take online courses in the Learning Center (5)
3. Organize two events to motivate club members to contribute to TRF (2)
4. Conduct three TRF Committee meetings (3)
5. Support CSP Committee to secure and implement a Global Grant project
6. Assist and facilitate implementation of five service projects in partnership with key actors in Godawari-Phulchowki conservation area (5)
7. Maintain EREY to continue securing 100% contributing club banner (55)
8. Pursue three club members to become PHF (3)
9. Motivate two PHF/MPHF members for additional PHF (2)
10. Inspire a second member to contribute to become PHS (1)
11. Explore possibilities to contribute to other Presidential Citations
12. Major donor (1)

Public Relation Committee:

Goals: (a) Contribute to build public relations; (b) Widely distribute Rotary publicity materials; and (c) Celebrate important and dedicated days to enhance public image and visibility, (d) Organize fund raising program, and (e) Maintain, update and publish club website, social media and media

1. Felicitate and award (vocational) non-Rotarians in the community (1 Event) with substantial amount and organizational costs by donors.
2. Explore to add one award; sign MoU with sponsor
3. Regular website maintenance and updates
4. Regular social media updates
5. Post Rotary logo and information in the project area and communities
6. Encourage to plant fruit tree and Rudraksha at health center, schools, Bihars and public places
7. Invite leaders from different walks of life at club programs
8. Distribute club's annual souvenir magazine in school/ college library
9. Provide Rotary magazine to clubs, clinics, libraries and schools
10. Send activity reports for GML regularly
11. Visible participation in culture program/tour wearing t-shirt and caps with Rotary logo (2 events)
12. Club participation in Polio Rally, World Cancer Day and other relevant events
13. Family-based product exhibition jointly with other organizations
14. Sale of T-shirt and caps with Rotary logo
15. Promote household waste management and rooftop gardening for Eat Organic and Be Healthy campaign
16. Rotarian – Non-Rotarian get-together interaction program.

Note: Detailed Annual plan and budget for 2023/24 will be prepared based on the tentative Actions indicated above.

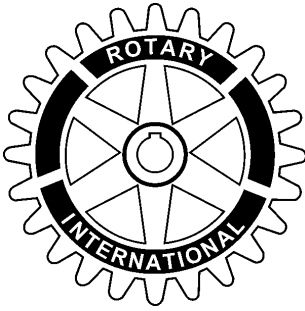

Bylaws of Rotary Club of Yala

First Amended on May 5, 2017
Second Amended on February 19, 2021
Third Amended on April , 2023
(As adopted by club meeting #1362)

Article 1 Definitions

- 1. Board:** The Board of Directors of this club.
- 2. Director:** A member of this club's Board of Directors.
- 3. Member:** A member, other than an honorary member, of this club.
- 4. Quorum:** One-third of the club membership; a majority of directors for the Board.
- 5. RI:** Rotary International.
- 6. Year:** The 12-month period that begins on 1 July.

Article 2 Board

The governing body of this club is the Board consisting of the president, immediate past president, president-elect, president nominee, vice president, secretary, treasurer, 5 directors, sergeant-at-arms, club trainer and editor.

Article 3 Elections and Terms of Office

Section 1 — Each year the president, in consultation with the board, constitutes a nominating committee comprising of two past presidents who have not been members of the immediate two past nominating committees and president elect of the club, chaired by the senior most past president in order to nominate a president nominee for the year next to next, a president nominee designate to serve after the president nominee and other members of the board for incoming year. Members of nominating committee are not eligible to be candidates but are eligible to vote in case of ballot. If a written challenge is received by the board against any nomination within the time stipulated by the nominating committee, the position will be determined by a secret ballot at a RWM. In case of voting, club members must be informed at least one week in advance, Proxy voting is not allowed.

Section 2 — The candidate who receives a majority of the votes for each office is declared elected to that office.

Section 3 — A vacancy on the Board or any office shall be filled by the remaining members of the Board.

Section 4 — A vacancy of any officer-elect position or director-elect position shall be filled by the remaining members of the Board-elect.

Section 5 — Terms of office for each role will be one year.

Section 6 — The President nominee designated must have previously served as a member of the board for a full term.

Article 4 Duties of the Board and key positions of the club.

Section 1 — President. The president shall preside at club and Board meetings.

Section 2 — Immediate Past President. The immediate past president shall serve as a director.

Section 3 — President-elect. The president-elect shall prepare for his/her year in office and serve as a director.

Section 4 — President Nominee. The president Nominee shall prepare for his/her year in office and serve as a director.

Section 5 — Vice President. The vice president shall preside at club and Board meetings in the absence of the president.

Section 6 — Director. A director shall attend club and Board meetings.

Section 7 — Secretary. The secretary is responsible to keep details of club members, records of club meetings with attendance record of participants and other club documents as well as copies of correspondence. In coordination with the president, treasurer, he/she is to complete renewal processes of the club as required by the prevailing Nepalese law within the month of Shrawan (Mid August).

Section 8 — Treasurer. The treasurer shall oversee and take custody of all club funds and keep necessary accounting records of daily transactions thereof. In

coordination with the immediate past treasurer, he/she is also responsible to conclude statutory audit of the books of accounts by a certified auditor appointed by the Club, to file online tax return and to get tax clearance certificate from the concerned tax office within the month of Shrawan (Mid August).

Section 9 — Every board member is to perform any additional duties as assigned by the board.

Section 10 – Sergeant-at-arms takes care and helps to maintain order in the club meetings.

Section 11 – The Trainer keeps himself update about the rotary international literature, culture, activities and events and always endeavors to educate all the members of the club as required to help members be pursuant to a ideal Rotarian.

Section 12 – The Editor is responsible to edit and publish club annual souvenir, maintains its quality and informative so as to build club image and make credible reading material for members and interested others.

Article 4 (a) Membership

Section 1 — Eligibility criteria for a member shall be

- a. As per the prevailing Nepal law on membership disqualification
- b. As per the New membership procedure approved by the Board
- c. Rotary membership principles set by Rotary international.

Section 2 — All the existing members shall be in compliance to this article.

Section 3 — The board may amend membership procedure as required.

Section 4 — The membership of the club is supposed to be terminated on the:

- a. Death of the incumbent member.
- b. Resignation by the members approved by the Board.
- c. Any condition prevailed under section 1 above.
- d. Termination decision made by the Board against failure to pay club annual dues under article 6 and violation of duties and responsibilities set by the club by- laws.

Section 5 — Terminating member is liable to pay any dues outstanding before the date of termination.

Article 5 Meetings

Section 1 — Annual Meeting. An annual meeting of this club shall be held no later than 31 December to elect the officers and directors who will serve for the next Rotary year.

Section 2 — The regular weekly meetings of the Club are held on Friday at 6.00 pm. Reasonable notice of

continuation or any postponement or cancellation of the meeting shall be duly circulated to all the members and concerned.

Section 3 — The regular weekly meeting(s) may be held online in unusual circumstances.

Section 4 —The Club may hold 1 (one) of its regular weekly meetings per month on virtual platform.

Section 5 — Board meetings are held each month on the day and time fixed by the board. Special meetings of the Board are called with reasonable notice by the president or upon the request of at-least two directors.

Section 6 — Annual General meeting will be held at the time of 1st Club assembly where the club's audited financial statements and progress report of the previous year, appointment of auditor for coming year and other agenda will be resolved.

Article 6 Fees and Dues

Section 1 — For a new member, an admission fee of Rs 5,000 (Five Thousand) shall be paid when the application for membership is approved by the board for the qualifying member.

Section 2 — Membership dues includes RI per capita dues, annual subscription of the Rotarian and Rotary regional magazine, rotary district per capita dues, club annual dues, and any other Rotary or District per capita due assessed by RI, district or the club. The Membership dues shall be in the amount of Rs 28,000 (Twenty-Eight Thousand) per capita per year payable on semi-annual basis. Any dues other than RI and District dues are not be mandatory, provided the decision of the board otherwise. Based on the general price level circumstances, fees and dues shall be reviewed by the board as it is considered.

Section 3 – Where both husband and wife are member of this club, the annual per capita dues as per section 2, shall be Rs. Rs 25,000 (Twenty-Five Thousand) only each.

Section 4 - For any incoming member, who is also the member of Rotaract Club of Yala, per capita annual membership dues under section 1 shall be Rs. 20,000 (Twenty Thousand) applicable for two succeeding rotary years.

Section 5 - Each member should pay the semiannual due by the 15th day of each semiannual period (i.e. July 15 and January 15). None compliance of this section shall attract membership termination clauses subject to the Board Decision otherwise.

Section 6 - Membership dues for a new member shall be equal to one-twelfth of the annual per capita dues for each full month of membership.

Article 7 – Method of Voting

The business of this club is conducted by voice vote or show of hands except for the election of officers and directors, which is conducted by ballot. The Board may provide a ballot for a vote on a specific resolution.

Article 8 – Committees

Section 1 — In order to coordinate the efforts of the club in achieving the club’s annual and long-range goals, the club will have the following standing committees:

- Club Administration
- Membership
- Public Relations
- Rotary Foundation
- Service Projects

Section 2 — Additional committees may be appointed as needed. Any ad hoc committee may be formed by the board as it is necessary to be formed.

Section 3 — The president and secretary shall be an ex officio a member of all committees and as such have all privileges of participation in the meetings.

Section 4 — Except where special authority is given by the Board, committees shall not take action until a report has been made and approved by the Board. The president or the Board shall refer additional business to a specific committee as needed.

Section 5 — Each committee chair shall be responsible for regular meetings and activities of the committee, shall supervise and coordinate the work of the committee, and shall report to the Board on all committee activities.

Article 9 – Finances

Section 1 — Prior to each fiscal year, the Board shall prepare an annual budget of estimated income and expenditures.

Section 2 — The treasurer shall deposit club funds in financial institution(s) designated by the Board, divided into two parts: club operations and service projects.

Section 3 — Bills are paid by the treasurer or another authorized officer when approved by president of the club.

Section 4 — A thorough annual review (annual audit) of all financial transactions shall be completed by a qualified auditor.

Section 5 — An annual financial statement of the club shall be provided to club members.

Section 6 — The fiscal year is from 1 July to 30 June.

Section 7 – Bank accounts of the club will be operated by joint signature of President and Treasurer.

Article 10 – Method of Electing Members

Article 10 A – Active Members

Section 1 — A member shall provide a candidate’s name to the Board. A transferring or former member of another club may also be proposed for membership by the former club. The proposal is kept confidential unless the Board instructs otherwise.

Section 2 — The Board shall ensure that the candidate meets all of Rotary’s membership requirements.

Section 3 — The Board shall approve or reject the candidate’s membership within 30 days and shall notify the proposer of its decision.

Section 4 — If the decision of the Board is favorable, the prospective member is invited to join the club, educated about Rotary and membership requirements, and asked to sign the membership proposal form and to allow his or her name and proposed classification to be conveyed to the club.

Section 5 — If no member of the club submits a written objection including reasons for the objection, to the Board within seven days after the club is notified of the prospective member, that person, upon payment of the admission fee, is considered to be elected to membership. If an objection has been filed with the Board, the club shall vote on this matter at its next meeting. If approved despite the objection, the proposed member is elected to membership after admission fee payment.

Article 10 B – Honorary Members

The club may grant honorary membership to distinguished personalities proposed by the Board.

Article 10 C – Corporate Members

The club may offer corporate members as mentioned in “Corporate Membership Bylaws” adopted by the Club.

Article 11 – Resolutions

Any resolutions or motions to commit the club to any position or action shall first be reviewed and approved by the Board. If resolutions or motions are first offered at a club meeting, they shall be sent to the Board without discussion. The modus operandi for proposing and approving the resolution will be similar to amendment of these bylaws.

Article 12 – Amendments

These Bylaws may be amended at any regular club meeting. Changing the club bylaws requires that written notice be sent to each member 10 days before the meeting, that a quorum be present for the vote,



CREATE HOPE
in the WORLD

and that two-thirds of the votes support the change. Changes to these bylaws must be consistent with the Standard Rotary Club Constitution, the RI Constitution and Bylaws, and the Rotary Code of Policies.

Corporate Membership Bylaws
(as adopted by club meeting on February 19, 2021)

Article 1 – Corporate Member – The club shall offer a corporate membership program for a corporation – or any business, nonprofit, government entity, professional practices, or educational institutions, an alternative membership package to some of its employees recognizing the growing importance that business place on corporate social responsibility.

1. Qualification: The employees of any business are eligible for Corporate Membership in the Rotary Club of Yala.
2. Members: Subject to the approval of the club's board, the business designates employees to serve as members of the Club and may appoint up to 3 people to be primary members and alternatives.
3. Attendance: Attendance and participation requirements of the Club may be met by any of the members.
4. Dues: As per Model 1
5. RI registration: Primary Corporate member for whom RI dues have been paid are registered as active members in Rotary's database.

6. Votes and Quorum For the purpose of general meetings and club matters, the primary corporate member is eligible to vote having only one vote.
7. Holding office: Any RI dues-paying member listed in Rotary's database, which includes the primary Corporate member, is eligible to hold office. Alternatives who do not pay RI dues are not eligible.

Dues Structure for Corporate members

Model 1: In which only the primary member is assessed dues and reported to Rotary International as an active member.

Primary Member - 1

Alternative member - 2

Membership dues – Rs 50,000 and Admission fee – Rs 10,000

Model 2: In which the Club assesses a flat rate for a certain number of corporate members.

For Two Corporate Member – Rs 90,000 and Admission Fee Rs 10,000 (Average cost, per member Rs 50,000)

For Three Corporate Member – Rs 110,000 and Admission Fee Rs 10,000 (Average cost per member Rs 40,000)

सामान्य निराशापन की डिप्रेसन ?

डिप्रेसन वा उदासिनता मानिसलाई हुने प्रमुख रोगमध्य एक हो । डिप्रेसन भनेको खाली मन उदास हुनु मात्र नभई यो रोगले हाम्रो सोचाई, भावना तथा व्यवहारमा पनि असर गरी निम्न लक्षणहरु देखा पर्दछ ।

हाम्रो सेवाहरु:

- २४ सै घण्टा मानसिक रोगको इमर्जेन्सी सेवा ।
- विद्युतीय माध्यमबाट उपचार गरिन्छ ।
- मनोवैज्ञानिक परामर्श सेवा ।
- ओ. पि. डि. सेवा (शनिबार बाहेक ।

"Dedicated in Mental Health"



पुनर्जीवन हस्पिटल

PUNARJEEVAN HOSPITAL

Balkumari, lalitpur.

tel: 01-5186115



एनएलजी इन्स्योरेन्स
कम्पनी लिमिटेड

Why You Must
Have A NLG
Car Insurance?
Because we have

Hassle-free claim settlement ✓

Customizable coverage options ✓

Friendly customer service ✓

सबैको सुरक्षा, एनएलजीको इच्छा

☎ 01-4442646, ✉ info@nlgi.com.np, 🌐 www.nlgi.com.np

We wish all

the best to

ROTARY

CLUB OF YALA

on the occasion

of its

27th Anniversary

We wish all
the best to
ROTARY
CLUB OF YALA
on the occasion
of its
27th Anniversary

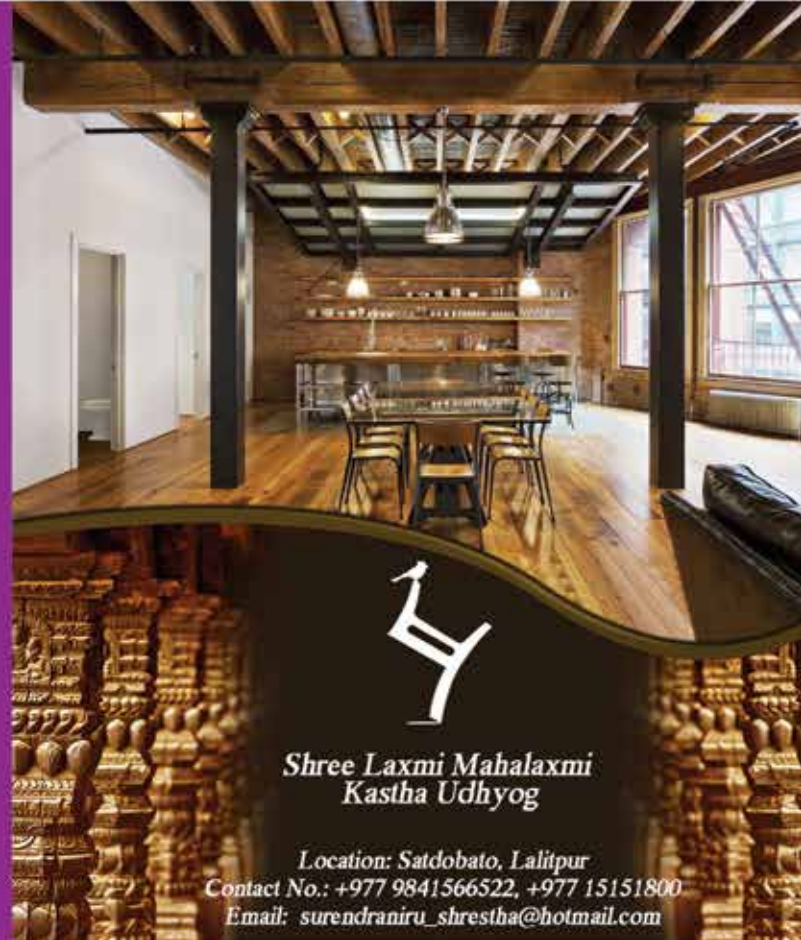

Shree Laxmi Mahalaxmi
Kastha Udhyog

Location: Satdobato, Lalitpur
Contact No.: +977 9841566522, +977 15151800
Email: surendraniru_shrestha@hotmail.com



नबिल ढुक्क बचत खाता

आकर्षक ब्याजदर र सुनौला फाईदाहरु लिई ढुक्क हुनुहोस् ।

बीमा सुविधा

प्राण घातक
तथा मृत्यु बीमा

रु ३,७५,०००

दुर्घटना बीमा

रु १०,००,०००

औषधी उपचार बीमा

रु १,००,०००

आजीवन निःशुल्क

- डेबिट र क्रेडिट कार्ड
-  bank (मोबाइल बैंकिङ)
- अन्य एटीएमबाट रकम किनन सकिने*



DMAT and Meroshare

पहिलो वर्षको लागि निःशुल्क



लकर सुविधा

पहिलो वर्षको लागि निःशुल्क र
पछिका वर्षहरुमा ५०% छुट

* खातामा रु १,००,००० को न्युनतम मौज्जात राखेमा उल्लेखित सुविधाहरु निः शुल्क पाईने

बीमा प्रदायक



NABIL BANK

TOGETHER-AHEAD



नेको इन्सुरेन्स लि.
NECO INSURANCE LTD.

बीमा गरौं,
किस्ता तिरौं



MOTOR LOSS OF PROFIT POLICY (MLOP)

सवारी साधन दुर्घटना भई, मर्मतका लागि ज्यारेजमा रहदाँ,
अर्को सवारी साधन चडन वा तीन (३) महिना सम्मको बैंक
किस्ता हामीले तिर्नेछौं ।

प्रस्तुत छ, नेपालमै नविन प्रविधिद्वारा उत्पादित ग्याल्भालुम तथा रंगीन जस्तापाता

**जगदम्बा®
सुपर शाइन**
प्रिमियम रङ्गिन Al-Zn सिट एण्ड कोइल्स

**जगदम्बा®
ग्याल्भा+**
प्रिमियम Al-Zn सिट एण्ड कोइल्स



उत्कृष्ट विशेषताहरू
को साथ
— जीवनभरको भरोसा —

जगदम्बा सुपर शाइन तथा जगदम्बा ग्याल्भा+ जस्तापाताको ७ विशेषताहरूले दिन्छ तपाईंको घरलाई सुन्दर आकार र सुनिश्चित गर्दछ तपाईंको परिवारको सुरक्षा

- | | | | | | | |
|---|--|--|-----------------------------|--|--|-------------------------------------|
| <p>१</p> <p>आधुनिक प्रविधिबाट उत्पादित ग्याल्भालुम तपाईंको घरलाई सुन्दर आकार र सुनिश्चित गर्दछ तपाईंको परिवारको सुरक्षा</p> | <p>२</p> <p>टिकाउ तथा खिया प्रतिरोधात्मक</p> | <p>३</p> <p>हरेक मौसमबाट पूर्ण सुरक्षा</p> | <p>४</p> <p>उच्च मजबुती</p> | <p>५</p> <p>उत्कृष्ट रंग कोटिङ्ग प्रविधि</p> | <p>६</p> <p>उत्कृष्ट गुणस्तर परीक्षण</p> | <p>७</p> <p>गार्ड फिल्म कोटिङ्ग</p> |
|---|--|--|-----------------------------|--|--|-------------------------------------|

आधुनिक प्रविधिबाट उत्पादित जगदम्बा सुपर शाइन तथा जगदम्बा ग्याल्भा+ जस्तापाता हो आधुनिक निर्माणको आधार

JAGDAMBA STEEL®

